



Rock County STAR HERALD

Rock County's oldest business, printing since 1873

Thursday, April 19, 2018

Weekend record April 'thunder blizzard' shuts down region

New snowfall adds to already record measurements

By Lori Sorenson

An April "thunder blizzard" of epic proportions stalled over southwest Minnesota Friday through Sunday night, delivering thunder, lightning, hail, gale force winds and record snowfalls.

Luverne volunteer recorder Troy Thone estimated more than 15 inches for the weekend — a new record.

"It's a tough one to narrow down since most of the snow blew horizontally," he said. "But I think that correlates well with the surrounding amounts."

Until Saturday, the April 2013 ice storm is remembered as coinciding with the snowiest April on record with more than 20 inches that month alone.

Thone said comparing his data with Sioux Falls climate information, Luverne's snowfall is at roughly 25 inches for the month.

"This definitely broke records in Sioux Falls — for both daily total and April total snowfall — by a large margin," Thone said. "I'd almost be certain Rock County records would also be broken in both areas."

Prior to this weekend, Rock County had registered nearly a foot of snow for April and more than 50 inches for the season.

Now, the tally surpasses 25 for the month — the new record — and 65 for the season, which is well above the seasonal average of 44 inches.

Luverne Public Works Supervisor John Stoffel said his crews moved 240 truckloads of snow out of the downtown area alone. That's twice the amount moved after last week's 6-inch snowfall.

He said an average snow cleanup requires 160 man-hours.

That typically includes 10 guys operating a variety of equipment, including four dump trucks with plows, snowblower, a road grader,

Snow records broken/see page 3A



Lori Sorenson photos/0419 storm power lines

Linemen work to repair damaged power lines at the I-90 overpass near Magnolia Friday morning after 70-mph straight-line winds snapped dozens of poles there and in other parts of the region.

Roads closed in entire southwest region of state; sheriff pleads with motorists to comply

By Lori Sorenson

At one point during the weekend blizzard, all state roads in southwest Minnesota were closed to traffic.

That included I-90 from the South Dakota border almost to Fairmont and US Highway 75 from the Iowa border to Canby and all other state roads in between.

These closures were announced early Saturday morning, and most weren't reopened until 10 a.m. Sunday.

Rock County Sheriff Evan Verbrugge said he appreciated these closures, and he hopes motorists understand the importance of heeding "road closed" announcements.

"We don't have magic carpets," he said Sunday. "We have cars just like you do."

On the Sheriff's Office Facebook feed, motorists were warned not to travel.

"You should all have been made aware of the potential blizzard that is coming to Rock County later this evening," he posted Friday afternoon.

"Please do not travel. Sheriff Verbrugge is not going to risk the lives of his deputies to go rescue someone that was warned for no travel. Please get home now or find a family member or hotel and stay there. If it is an emergency, please call 911 and we will work with you."

Verbrugge said some people objected to his approach.

"I'm okay with that," he said Sunday. "If people drive around barricades, we should not have to risk our lives for that."

In addition to opening the Luverne National Guard Armory for stranded motorists and those without

Roads closed/continued on 8A

Downed power poles darken towns

By Lori Sorenson

Hundreds of area residents began their record-breaking blizzard in the dark after 70-mph straight-line winds snapped nearly 90 power line poles in Rock County and southwest Minnesota.

The event prompted a temporary outage around 7 a.m. Friday lasting several minutes for much of southwest Minnesota, including Luverne.

For others, however, it was a long, cold, dark weekend without the modern comforts afforded by electricity.

The Hills-Beaver Creek and Ellsworth school districts canceled classes Friday in the absence of power. Power was restored later on Friday at Hills and Beaver Creek.

"When that storm hit, it was so loud. ... My lawn furniture was flying around, the poles were coming down."

— Kris Knutson, Magnolia

Ellsworth students extended their long weekend through Monday when power remained out of reach for those customers on Nobles Power Cooperative.

The Ellsworth grocery store accommodated customers Fri-

Power outage/see page 3A

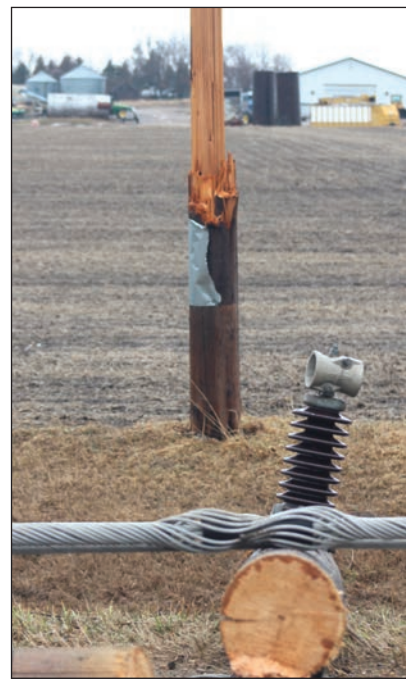

Magnolia teens spend Friday in armory waiting for electricity in SYS building

By Lori Sorenson

Amid other storm impacts over the weekend, a widespread power outage displaced 26 resident students and 10 staff members at Southwest Youth Services in Magnolia.

The students and staff spent all Friday in Luverne after Gov. Mark Dayton issued an executive order allowing the Minnesota National Guard

to shelter affected storm victims in the Luverne armory.

SYS office manager Amber Shaw, Hardwick, described the day as "apocalyptic" after driving through hail and tornado conditions that sent a tree branch into the side of the car near Kenneth.

"I saw this debris coming at me, and I swear it was a tornado," Shaw

said. "And then I got to work and there were trees down and no power."

Shaw said she worked frantically to get incoming SYS calls transferred to the director's phone while helping to transfer operations to the armory.

Meanwhile, Sioux Valley Energy arranged to connect the SYS building in Magnolia (the former school) to a generator, and by 5 p.m. the students

and staff had returned home — well ahead of the snowstorm.

"It was the biggest generator I've ever seen in my life," Shaw said. "By making the 3-point generator available to us, we agreed to make our facility available to Magnolia residents who might need shelter."

As it turned out, no residents utilized the service, but Sioux Valley

Energy turned the SYS building into a command center for operations.

"We had 40 linemen here for lunch and meetings," Shaw said. "It was very cool — I hope it never happens again, but it was neat to see."

By Sunday night Magnolia had power after wind-damaged power poles could be repaired (See the related story.)

School construction project prompts long days in district calendar for two years

By Mavis Fodness

For the next two school years Luverne students will be in class an extra half hour each day.

Classes will be in session from 8 a.m. to 3:30 p.m. for both the 2018-19 and 2019-20 school years.

Traditionally the Luverne school day is from 8:15 a.m. to 3:15 p.m.

Board members unanimously approved the school calendars for the next two years at a Thursday, April 12, meeting.

The result means construction personnel now have a four-month window during the 2019 summer to complete as much of the planned \$30 million school renovation project as possible without students on the campus.

"Next year will be a normal start time for us ... with students starting after Labor Day," said Superintendent Craig Oftedahl. "But we will get out early."

2018-19 school year

Classes start Sept. 4 and end on May 10, 2019. Graduation is May 12, 2019.

2019-20 school year

Classes start Sept. 16, 2019, two weeks after Labor Day, and end on May 22, 2020. Graduation is May 24, 2020.

In the 2018-19 school year, students will begin class Sept. 4 and end on May 10, 2019. Graduation will be May 12, 2019.

In the 2019-20 school year, students will begin class on Sept. 16, 2019, two weeks after Labor Day. Classes will end on May 22, 2020. Graduation is scheduled for May 24, 2020.

A survey of school staff revealed 74 percent of the 130

employees who voted favored extending the school day. The district employs about 200 people.

Oftedahl presented three school calendar options to board members over the past two months.

Two options lengthened the school day by 30 minutes and one option kept the same class schedule but began classes before Labor Day.

The approved options met the Minnesota Department of Education's criteria of 165 student days with an additional 6.3 staff insertive/workshop days.

In other business, the board:

- approved a leave of absence for Tiffany Veal, special education teacher, for the remainder of the school year.

- accepted the resignation of Rebecca Redetzke, chemistry and physics teacher, effective at the end of the 2017-18 school year.

School calendar/see page 3A

Luverne snowmobiler dies in crash near Beaver Creek

By Lori Sorenson

A young man from Luverne was killed in a snowmobile crash Saturday night during the blizzard.

According to the Rock County Sheriff's Office, 28-year-old Jacob Gonnerman was traveling along County Road 4 around 10 p.m. Saturday when his snowmobile collided with a guard rail near the I-90 underpass just west of Beaver Creek.

A Rock County snowplow assisted with rescue efforts by clearing snow ahead of emergency response personnel in order for them to get to the crash scene.

City of Beaver Creek Public Works Department also assisted with snow clearing, according to Sheriff's Office reports.

Gonnerman was transported to Sanford Luverne where he was pronounced dead.

The Beaver Creek Fire Department, Rock County Ambulance and the Minnesota State Patrol also responded at the scene.

According to reports, Gonnerman had been wearing a helmet and was traveling with another snowmobiler.

The crash is under investigation and the BCA lab will conduct toxicology tests.

Gonnerman, son of Ronald and Mary Lou Gonnerman, Luverne, leaves behind a wife, Courtney, and two small children.

He was a welder at Virg's Welding in Sioux Falls and also owned and operated J&N Power Washing in Luverne.

The funeral service is at 10:30 a.m. Friday at Grace Lutheran Church, and visitation is from 4 to 8 p.m. Thursday, also at the church. The complete obituary appears on page 7A.



COMMUNITY CALENDAR

Meetings

Parkinson's Support Group will meet at 1 p.m. Thursday, April 19, at St. John Lutheran Church in Luverne. Speaker Gary Pauley PWP will speak on the journey of Parkinson's disease. Call 507-530-3307 with questions.

MS Support Group will meet at 7:30 p.m. Thursday, April 19, at Southwest Health and Human Services in Luverne. All persons with MS, family and friends are invited. Call 283-2069 or 283-2964.

Regional Autism Network Group will meet from 6:30-8 p.m. Monday, April 30, at the Worthington High School Media Center. The program is free, and interpreters are available. A medical doctor will discuss sensory integration. Call Allison Eitrem at 507-920-6334 with questions.

Additional food shelf hours

Rock County Food Shelf will add additional hours on the third Thursday of the month. The food shelf is open every Thursday from 1 to 3 p.m. and will also be open from 5 to 6:30 p.m. April 19, May 17, and June 21. The food shelf is located at the United Methodist Church with alley access. Call Mary at 507-227-5548 with questions.

Students perform 'Hats' April 20

The first- and third-graders at Luverne Elementary School invite the public to their program, "Hats," at 2 p.m. Friday, April 20, in the Luverne Elementary Gym.

Hospice Dinner and Auction April 21

Plans are set for the Sanford Luverne Hospice Dinner and Auction April 21 at Grand Prairie Events in Luverne. Doors open at 5 p.m. for the silent auction and raffles. Dinner will be served at 7 p.m. followed by a program and live auction. All proceeds stay local to support the Hospice program.

Bike Blessing at UMC April 22

The United Methodist Church in Luverne will host a "Bike Blessing" following the 11 a.m. worship service Sunday, April 22. From bicycles to motorcycles, everyone is welcome.

Ecumenical Coffee May 2

The First Presbyterian Church invites all area women to their annual Ecumenical Coffee Hour at 9:30 a.m. Wednesday, May 2. Speaker Judy Rops will present the program titled "Song of Hope," in which she shares her experiences as a breast cancer survivor and her mission trip to Palestine.

Library hosts author Brian Freeman

The Rock County Library in Luverne will host Minnesota Author Brian Freeman at 7 p.m. Thursday, April 26, at the library.

LPEP hosts Conversation April 26

Leaders Partnering to End Poverty (LPEP) will host a Community Conversation and free meal from 6-8 p.m. Thursday, April 26, at Grand Prairie Events.

To register, call ATLAS at 507-449-5777. Child care and transportation assistance are available upon request.

Help plant food forest April 26-28

Your help is needed to plant a public food forest at 308 North Blue Mound Avenue in Luverne. The work times are from 10 a.m. to 8 p.m. Thursday-Saturday, April 26-28, and volunteers may work any length of time during those hours. Please bring shovels and spades of all sizes, wheelbarros, pitchforks and large wire cutters as able. For more information, contact Kim Rockman at 507-353-0041 or email kimberlyelizabeth@live.com.

Knights Tootsie Rolls April 28

The Luverne Knights of Columbus will be conducting their annual Tootsie Roll Fundraiser for Intellectual Disabilities at Teal's Market and Shopko on Saturday, April 28. Proceeds are donated to Rock County Opportunities (RCO). Contact Randy Walgrave at 507-220-0332 with questions.

Silent movie postponed to April 29

The silent movie, "The Freshman," will be shown at 2 p.m. Sunday, April 29, at the historic Palace Theatre in Luverne, featuring Leona Hoek on the classic theater organ. Admission is \$7 for adults and \$5 for children.

Hospice reaches 25-year milestone

By Lori Sorenson

A familiar face will be in attendance at the Sanford Luverne Hospice Dinner and Auction Saturday night.

Barb Glad was the first director of the local Hospice program that began 25 years ago at a time when dying well was a strange new concept.

In 1993 people still hesitated to talk about dying, but people with terminal illnesses and their loved ones were beginning to understand the importance of end-of-life care.

And Glad was at the helm to guide this new way of serving patients and their families in Luverne.

Today, 25 years later, the local hospice program is thriving, and Glad shared with the Star Herald what she recalls from those early experiences with the program.

What were your goals when you started the program?

My initial goal was to establish a Medicare certified Hospice program for the hospital so terminally ill patients and their families would have the kind of care and support that hospice can provide. My concern was to establish a strong Hospice program that would survive and thrive in my absence - I think that has happened. Being married to a United Methodist pastor, I knew I would not be a permanent resident of Luverne.

I also dreamed of a Hospice Cottage but realistically I didn't think that dream would come true.

What did you see as the biggest challenge?

Hospice care for the terminally ill was a fairly new concept from England which came to the USA in 1974, and was not Medicare certified until 1982, only 10 years before starting the program in Luverne.

People in the area were familiar with the name "Hospice" but didn't have an understanding of Hospice care under the Medicare benefit.

So providing education and orientation for hospice staff, volunteers, hospital in-patient staff/physicians, nursing homes, and the community was a huge challenge.

Establishing policies and procedures for Medicare certification for Hospice, Home Care and the Cottage was also challenging since each is regulated by separate state and federal guidelines.

Networking with Prairie Home Hospice in Marshall and the Redwood Falls Hospice was extremely helpful.

What was the most satisfying about your work in Luverne?

The overwhelming interest and support of so



In 1997 the Hospice Community Advisory Committee began writing the policies and procedures for a Hospice Cottage in Luverne. Ground-breaking was on March 30, 1998, and on Sept. 19, 1998, the Cottage became the first out-state Medicare-certified Hospice Cottage in the State of Minnesota. This photograph was taken in December 2017.

The Sanford Luverne Hospice Dinner and Auction is April 21 at Grand Prairie Events in Luverne. Doors open at 5 p.m. for the silent auction and raffles. Dinner will be served at 7 p.m. followed by a program and live auction. All proceeds stay local to support the Hospice program.

Saum: It is my privilege to be part of this program

By Lori Sorenson

Helen Saum is the volunteer coordinator for Hospice and has been largely responsible for the success of the annual banquet, which has brought in hundreds of thousands of dollars over the past two decades.

The Star Herald asked Saum to reflect on her role with the program in the 20 years she has worked for it.

How has the charity banquet and auction affected the program?

I think over the years Hospice has touched the lives of many people - a loved one, neighbor or friend, and they have seen the quality of care and the support received at the end of life.

This is something important that they want for their loved ones and may need themselves someday.

Also, Hospice is involved with families at a very personal time and as a result, people often want to give back - whether it be financial support or getting involved as a volunteer for Hospice.

Volunteers are an important aspect of Hospice, helping provide direct support to patients and families; administrative help in the hospice office; and/or those who step forward to be involved by serving on the Hospice Advisory Board and with fundraisers.

The businesses and individuals in our communities are very generous with their time, service and financial support for things that are important to them and the community. Hospice has been extremely fortunate to receive such remarkable support.

Why do you think there's such a generous response to the annual fundraiser and for all things Hospice in this community?

The Hospice Charity Dinner and Auction was started in the early years as a way to raise money and community support to build a Hospice house.

The fundraiser has grown and continues to be a critical source of financial support today for the Hospice program to offset inadequate reimbursement from Medicare and insurance.

Hospice receives a per diem for each patient under its care, which does not cover the actual cost of the services and expenses.

The program would not be able to provide the high level of personalized care and continue to do what we do without this continued support.

Why have you stayed with your role in the organization for 20 years?

I got involved after losing my own mother from a difficult battle with cancer. There was no Hospice care available at that time where she was living.

I wanted to be a part of something that would offer comfort, dignity and a quality of life for those living with a terminal illness and support for their families.

Today we are very fortunate to have excellent medical expertise, dedicated volunteers, and the option of specialized care at The Cottage. It is my privilege to be a part of this program.



many for the program really energized me.

I'm thinking of Jerry Carl, hospital administrator, the hospital board (especially Gordon Gits who was a strong supporter), the Hospice Community Advisory Committee (I could not

have done it without them - especially Betty Luethje and Mike Cox), the physicians (services could not be provided without an order),

the first staff members (Mary Thone, Carole Ihnken, Doris Korthank, and Dr. Tim Ceynowa ... others were added later), and last but not least, all the awesome volunteers.

Words of appreciation from the Hospice families were so inspiring. Knowing that terminally ill patients and their families were receiving care and support was very gratifying to me.



What was the most important consideration as we observe 25 years of hospice?

It takes a village for Hospice to happen: staff, volunteers, physicians, support from administration and hospital board, and everyone in the community. The Luverne community can be proud of having supported terminally ill patients and families for 25 years. They have been a good village for Hospice. All the best and every blessing for many years to come.



Dial-A-Specialist

Your One Stop Guide to Local Businesses

 <p>DR. MICHAEL SMITH Most Insurance Accepted</p>	 <p>• Men, Women & Children's Health • Custom Orthotics • Kinesiotape • Athletic Care • Massage Therapy • Work & Auto Injuries • Postural Restoration</p> <p>WWW.ROCKCOUNTYCHIROPRACTIC.COM 283-2561 • 103 E. MAIN, LUVERNE Monday 7:30 a.m. - 6 p.m. • Tuesday 7:30 a.m. - 3 p.m. Wednesday 7:30 a.m. - 6 p.m. • Thursday 7:30 a.m. - 1 p.m. Friday 7:30 a.m. - 5 p.m.</p>	 <p>Chantel Connell Sales Representative</p>	 <p>Rick Peterson General Manager</p>
• Chiropractic	• Advertising	• Chiropractic	• Computer
 <p>Rock County EYE CLINIC 507-283-2345 104 N. Freeman Ave. Luverne, Minnesota</p>	 <p>Papik MOTORS 1-90 Luverne, MN Box 536 • 801 West Commerce Road Luverne, MN 56156</p> <p>(507) 283-9171 (800) 634-7701 www.papik.com</p>	 <p>Luverne MINNESOTA City Offices Love the life! PO Box 659, Luverne, MN 56156 507-449-2388 (24 hour voice mail) www.cityofluverne.org</p>	<p>Dakota Land Surveying and Engineering, Inc.</p>  <p>Steven B. Kor Professional Engineer Registered Land Surveyor</p> <p>2000 W. 42nd Street, Suite B-6 Sioux Falls, SD 57105 605-334-4882 605-334-5745 Fax</p> <p>506 Almar Luverne, MN 56156 507-283-3803 steve.dis@midconetwork.com</p>
• Eye	• Automotive	• City	• Land Surveying

Storm snaps power poles, some communities in dark for days/continued from page 1A

day and through the weekend by manually adding up purchases and allowing customers to return later for payment.

The city of Ellsworth offered a heated fire hall for refuge and made gas available at the fire hall to residents for their generators so they wouldn't have to travel to get gas.

Other small businesses without generators were saddled with financial losses and inconveniences.

For example, Kris Knutson operates a hair salon out of her home just south of I-90 near Magnolia.

That's where Minnesota Department of Transportation officials closed the Magnolia exits after 54 power poles snapped off and fell onto the road, blocking travel in both directions on County Road 3.

Knutson canceled her appointments, and not knowing when power would return, she was unable to reschedule them for the coming days.

"It's been a crazy few days," she said Tuesday morning from Sioux Falls where she had stayed with her daughter Alexis during the outage. "When that storm hit, it was so loud. ... My lawn furniture was flying around, the poles were coming down."

Her property escaped damage, but the outage added up to lost income Friday, Saturday, and Monday in the dark.

She had hoped to schedule some clients Tuesday afternoon and many were rescheduled for later, but many sought services elsewhere.

"I have my Friday appointments when they come in to get their hair done, and they had someone else do it," she said. "Everyone was so gracious, because you can't help it. But what a pain."

Other small businesses, such as the Ellsworth Food Center, scrambled for generators to save inventory and serve customers.

Owner Mike Lewis said he connected the store to a rented 3-phase generator around noon on Friday. That was after roughly 30 customers came through the door for groceries.

"We wrote a lot of slips," he

County tallies storm costs, declares disaster

By Mavis Fodness

Rock County Commissioners signed a formal disaster declaration Tuesday morning to recoup some of the \$830,000 in estimated damages caused by Friday's blizzard.

County administrator and emergency management director Kyle Oldre said the majority of the costs were related to the damaged electrical lines.

Sioux Valley Electric Cooperative, Coleman, South

Dakota, estimated \$500,000 to replace the 60-70 power-line poles damaged by high winds Friday morning.

L&O Power Cooperative, Rock Rapids, Iowa, estimated \$250,000 in damages to 30 downed transmission poles.

An additional \$80,000 was incurred in extra expenses in Rock County and its municipalities due to the storm.

With the declaration, the expenses would be eligible for 75 percent reimbursement from the state.



When snapped power poles lay across County Road 3 on the I-90 overpass, Magnolia exits were blocked from both directions until Monday. Sioux Valley Electric estimated \$500,000 to replace the 60-70 power-line poles damaged by high winds.

said. "We added them up on a calculator."

Livestock farmers were also affected by blizzard losses, especially those in the middle of calving season.

Most operations have adequate shelter for cattle to seek refuge in from the wind, but the temperatures and conditions caused at least some losses of new calves.

Area businesses fortunate enough to have power reported financial gains from the storm.

For example, Howling Dog bar and grill on South Highway 75 in Luverne had a parking lot full of Sioux Valley Energy trucks and equipment Sunday night.

"We were really busy all day yesterday," owner Jodi Reverts said Monday. "We had 30 linemen come in at 8 for supper. They'd called ahead to see if we could feed them late."

She said their customers



This photograph was taken around mid-day Friday of snapped power poles lying over County Road 3 near Magnolia to the south of the overpass facing north.

had urged them to stay open Saturday, but conditions were so bad she decided against it.

"I got out of my car and I could hardly see," Reverts said. "I just didn't think it would be

a good idea to be open, for our sake or our customers."

The Grand Stay Hotel and Suites also saw increased business due to the blizzard, according to general manager

Tyler Hulstein. "We got a lot of extra business during the storm," he said.

In addition to stranded motorists, he said Ellsworth and Magnolia residents

spent the weekend when those communities lost electricity.

Also Hulstein said 15 rooms were occupied by linemen working for area utility companies working to restore power for local cooperatives.

According to Sioux Valley Energy, roughly 770 of its members were without power due to roughly 90 downed power poles.

These included the towns of Magnolia, Kanaranzi, Hills, Beaver Creek, Steen, Ash Creek, Ellsworth and Lester, along with rural areas as of 10 a.m. Friday.

Sioux Valley Energy and Nobles Cooperative assisted each other, along with crews from Redwood Electric Cooperative, Lyon-Lincoln Electric Cooperative, East River Electric and Karian Peterson Construction.

Posts from their Facebook feeds reported dismal working conditions in poor travel visibility, treacherous roads and relentless winds.

"This storm created some very challenging conditions for us to work through," said Sioux Valley Energy CEO Tim McCarthy on a Monday morning Facebook post.

"A special thank you to those in the Magnolia area. Our line workers really had their work cut out for them in this area in particular and we were very happy we were able to get the system rebuilt to the point we could get your power restored last night."

Work was suspended for a good share of Saturday during the worst of the blizzard, which carried sustained winds of 35- to 40-mph driving heavy snow that caused zero visibility and deep drifts.

Sioux Valley reported that Steen and portions of Hills had power restored by 11 a.m. Friday, with the rest of Hills online later Friday.

The lights came on in Beaver Creek at 5 p.m. Saturday.

The Magnolia feed was energized at 8 p.m. Sunday. The I-90 exits were reopened Monday.

Customers in Ellsworth remained without power Monday but were returned to the grid Monday night.

Junk cleanup rescheduled

By Lori Sorenson

Winterlike spring weather has prompted the city of Luverne to postpone its annual spring cleanup days one week.

Residents had been instructed to place items on their curbs April 23-26. Now they're asked to participate April 30 through May 3. Details and route dates are in the city ad on page 8A.

City employee Robyn Wessels said the forecast still looks like winter, and if household items get rained and snowed on, it complicates the cleanup process.

"We ended up canceling it in 2013 after the ice storm," Wessels said. "Rescheduling gets difficult

because of everything else that goes on in the spring."

For example, she said the city is expecting the delivery of 150 trees next week that will need planting, but first stumps need to be ground out from the ones that were taken down.

Also on the schedule is the citywide rummage sale May 3-6, and on the heels of that are preparations for community events, when it's not ideal to have junk piled on curbs.

"Spring cleanup is a service we like to offer our residents," Wessels said. "And we also want to promote community pride, so timing is important."

Adjust gardening schedules for late spring

More snow!!!!!! Not so exciting for us gardeners who want to get planting, but we are along for the ride just like everyone else.

With added snow — moisture — I want to remind you not to try to till your garden soil too soon.

If you take a fist full of soil and squeeze it and it forms a tight ball, the soil is too wet, and working at that point will result in damage to the texture of the soil — an issue that will plague you for the rest of the growing season.

If that fist full of soil will crumble easily, the soil is ready to be tilled.

That was the easy lesson ... patience is harder. The day's length has increased dramatically meaning most of our house plants are really waking up from their winter rest.

Now is the best time to repot any indoor plants that need to be revived. If the plant has grown out of



KNOW IT AND GROW IT

By George Bonnema, Luverne Flowers

proportion with its pot or if it seems to be root-bound, it is pleading for an "adjustment."

When selecting a pot, don't go overboard ... just one inch larger in diameter than the container the plant has been growing in is what I recommend.

When you remove the plant from its container and the soil mass looks extremely root-bound, use a sharp knife to cut about an inch of roots off all around the root ball.

That is called root pruning and will stimulate new root development and renewed energy for the above portion of the plant.

With a plant like a hibiscus, that root pruning and repotting should be accompanied by a haircut for the plant itself as well.

Waiting until April and the consequent lengthening days will result in a quick recovery time and new growth that will be much more proportioned and re-energized.

If you are an African violet fan, this is a great time to start new plants from leaf cuttings.

The time required for rooting will be short and you can have wonderful new blooming plants for the winter season.

I remove a mature leaf

or two, set them in about one half inch of water and keep them in bright sunlight.

When they root, I plant them in a small pot. In a couple of weeks, new little leaves will push up from the base and often there will be several new plants on each leaf stem cutting.

When those babies are large enough to handle, I separate them and plant them in individual pots, again selecting a small pot.

Violets bloom best when they are slightly root bound — too large a pot will result in a big happy plant with few if any flowers.

Faces of Hope banquet April 21

The Southwest Crisis Center will honor five area residents as their "Faces of Hope" Saturday night, April 21, at their annual banquet. The event starts at 6 p.m. at the Hiawatha Lodge in Pipestone.

Meghan Maes is the Rock County nominee. Other nominees include Angie Titus, Jackson County, Andrea Bloch, Nobles County, Cassie Loeffler, Pipestone

County, and Jess Reimer, Cottonwood County.

"Faces of Hope" recognizes people making a difference in the lives of individuals and children experiencing domestic and sexual violence.

Tickets can be purchased at www.mnswcc.org. All funds raised help provide services to survivors and their children.

School calendar/from 1A

- hired Jodi Nelson as long-term substitute special education teacher for the remainder of the school year;

- hired Austin Maxwell, special education teacher for a salary \$39,422 beginning with the 2018-19 school year.

- hired Matthew Watnemo as social studies teacher and ninth-grade girls' basketball coach for a salary of \$43,660

beginning with the 2018-19 school year.

- hired Lowell Schelhaas and Scott Kruger as custodians effective April 3 and April 23, respectively.

- hired Barb Antoine as middle school boys' tennis coach.

- hired Jon Schomacker as 2018 summer recreation coordinator for a salary of \$8,600.

Happy 75th Birthday
Jim Johannsen
Birthday Party Celebration
April 27 6-9 p.m.
Luverne Eagles Club
Greetings may be sent to:
Mary Jane Brown
110 S. Walnut Rm.#110
Luverne, MN 56156

Happy Birthday
LAWRENCE KLOOSTER
90th Birthday
Wednesday, April 25
Greetings may be sent to:
200 Oak St., Luverne, MN 56156

Happy 50th Anniversary
LYLE & GLORIA NELSON
on April 27
Greetings can be sent to:
1209 N. Linden St., Luverne, MN 56156

Open House Bridal Shower
Aimee Moss
bride-to-be of
Brenton Richters
SAT., APRIL 21 • 10 AM
American Reformed
Church, Luverne
Couple is registered at:
Luverne Ace & Target

HAPPY 80th Birthday
CARD SHOWER FOR
KEN BOWEN
FRIDAY, APRIL 27
Send greetings to:
2419 180th Ave.
Edgerton, MN 56128

Justin Kemp
Owner
*Commercial
*Business
*Residential
*Ag *Industrial
PO Box 803 • Luverne, MN 56156 • 507-920-6961

Six days of babysitting turns into lifelong bond with granddaughter

My granddaughter arrived at my doorstep last week for her first sleepover.



RUMINATIONS

By Mavis Fodness, Reporter

Jayden and I looked at each other as if we were on our first date alone together.

I admit spending six days caring for a 10-month-old seemed daunting. After all, it's been more than 20 years since I cared for a toddler.

Would the various cries, grunts and hand gestures still mean the same things after all these years?

Would she cry uncontrollably because she missed her parents? Would she be afraid to sleep comfortably in unfamiliar surroundings?

Fortunately, little Jayden came with instructions.

The dozen or so lines jotted by my daughter on a notebook page gave me an idea of when Jayden would wake up each morning — her usual nap times — when she eats and what time she goes to bed.

My son-in-law placed the bounty of baby food, formula and snacks on the counter. We were all set for the adventures in babysitting to begin.

As soon as the door closed behind her parents, I reviewed the child care instructions. It was after suppertime and bedtime was fast approaching.

Jayden and I looked at each other as if we were on our first date alone together. In essence, we were getting to know each other for the first time.

Since her birth last May, I have made the four-hour round trip regularly to see her every few weeks. I would stay overnight, and occasionally her parents would leave me in charge for a few hours.

Now I would be in charge 24/7 for several days.

On her way out the door, my daughter reminded me to post pictures on Facebook, Snapchat and Tiny Beans every

day. FaceTime was set up on the iPad with a fast tutorial on how the video chat application worked.

I was overwhelmed with the need to use all these apps during the coming week. It was more frightening than taking care of a child.

Faced with the daunting task of daily posts, I faithfully took pictures of Jayden feeding her snacks to the dog, going on one of two stroller rides we managed to get in before it began to snow, rocking in the toddler swing, and shopping in Luverne for the first time with Grandma.

Placing the postings allowed me to reflect on the time I spent getting to know Jayden.

The time with her was a blast!

She slept through the nights. She happily emptied my bedroom closet of its shoes. We managed to video chat with her parents.

That same video chat now works the other way. Two days after she returned to her Iowa home, I used FaceTime to see the new love of my life.

Our first date turned into a lifelong bond between granddaughter and grandmother all because of six days spent alone together.

Commentary: Pay what you can afford, strengthen the MinnesotaCare pool

GUEST EDITORIAL

By Jan Malcolm Minnesota Health Commissioner and Chuck Johnson, Acting Minnesota Human Services Commissioner

For nearly three decades MinnesotaCare has been a trusted choice for health care coverage, providing an affordable option for working people earning too much to qualify for Medicaid but not enough to afford traditional insurance.

We now have a chance to take the sensible step of allowing all Minnesotans to buy into the program, paying their own way for high-quality, more affordable health coverage.

This common-sense solution would help an estimated 100,000 more Minnesotans access the insurance they need, at prices they can better afford — more than double the number served today.

This proposal comes at a good time. While Minnesota has a solid record on providing affordable health coverage, recently there have been troubling signs. A recent Minnesota Department of Health survey showed nearly 339,000 Minnesotans did not have health insurance in 2017.

That's 116,000 more than in 2015.

Those statistics come to life in stories from all around Minnesota. The Minnesota Farmers Union reported the cost of health insurance dominated its statewide listening sessions, including the story of a couple who would incur more than \$40,000 in out-of-pocket costs before seeing a benefit from their insurance.

Amid these concerns, Minnesotans have voiced strong support for

expanding MinnesotaCare so anyone can buy in, as Gov. Mark Dayton proposed this year for a second time.

More legislators need to take these voices to heart if this solution is to succeed. We encourage policy makers to consider these five things as they weigh this issue:

1. The MinnesotaCare Buy-in builds on what works. Created by a bipartisan group of policy makers, MinnesotaCare enjoys broad support. It helps people address urgent health needs, but it does more than that. People who are insured are more likely to get the preventive care they need to keep small problems small.

2. Costs would be lower than the private market. The MinnesotaCare Buy-In would cost, on average, 28 percent less than the expected cost for commercial health plans, and enrollees would be eligible for significant tax credits.

Meanwhile, the buy-in would reimburse health care providers at the same rate as Medicare, strengthening the financial health of small, often

rural practices and local hospitals.

3. Enrollees would pay their own way. This is not free health care. Individuals who choose the MinnesotaCare Buy-in would pay their own way, meaning the cost of their premiums would pay for their coverage.

4. The buy-in would be sustainable over time. After minimal start-up costs, enrollee premiums would pay for the program. The MinnesotaCare Buy-in option is a more fiscally responsible and sustainable solution than costly and short-term alternatives such as premium discounts and reinsurance.

5. This is a common-sense approach. By building on the successful MinnesotaCare program, we add an affordable choice to the marketplace — that's especially valuable in the five counties where only one health plan was available this year.

The MinnesotaCare Buy-in won't solve all health care problems, but it meets an important need and helps 100,000 more Minnesotans get health care. That's a good start.



State troopers now carry Narcan to reverse effects of opioid drug overdoses

Question: I heard the Minnesota State Patrol is carrying around some stuff to help people that might have an issue with opioid abuse. Can you talk more about that? Thanks for all you do!

Answer: A Minnesota state trooper's job is surprisingly varied. Sure, you'd expect them to patrol the highways enforcing traffic laws and to help motorists in trouble. But saving people from drug overdoses might not have occurred to you.

Opioid abuse is becoming more and more widespread, and the State Patrol has had their eye on the issue. In Minnesota alone, drug overdose deaths increased 17.9 percent from 2015 to 2016, and those who use opioids have a lot to choose from: heroin, morphine, oxycodone, hydrocodone, fentanyl and codeine, just to name a few.

So starting in January, Col. Matthew Langer, Chief of the Minnesota State Patrol, issued a general order requiring every state trooper to carry Narcan. Narcan is the brand name for a prescription medication called naloxone, and it is sprayed into the



ASK A TROOPER

By Sgt. Troy Christianson, Minnesota State Patrol

nose to reverse the effects of opioid drug overdoses.

"It's important for troopers," said Langer, "because we're deployed all over the state and find ourselves in different situations, assisting other agencies and the public."

Specifically, troopers on patrol duty, evidence handling, and in situations where opioid exposure is a possibility must have naloxone at the ready. Troopers receive special training so that they can recognize the signs of opioid overdose and learn to administer naloxone.

Once a trooper administers a dose of naloxone, they have to assign a case number and write a field report.

They also have to fill out a form for the Department of Health. This helps them keep tabs on the opioid crises and what's being done about it.

There's another reason troopers carry naloxone. Yes, it's about keeping the public safe — but it's also about keeping troopers themselves safe. Let's say a trooper is searching a vehicle after a crash, looking in the glove compartment or center console. If their bare skin comes into contact with even a dusting of fentanyl, for example, it could be lethal.

Langer explains, "Narcan will help people who intentionally ingest drugs and first responders who inadvertently come into contact with

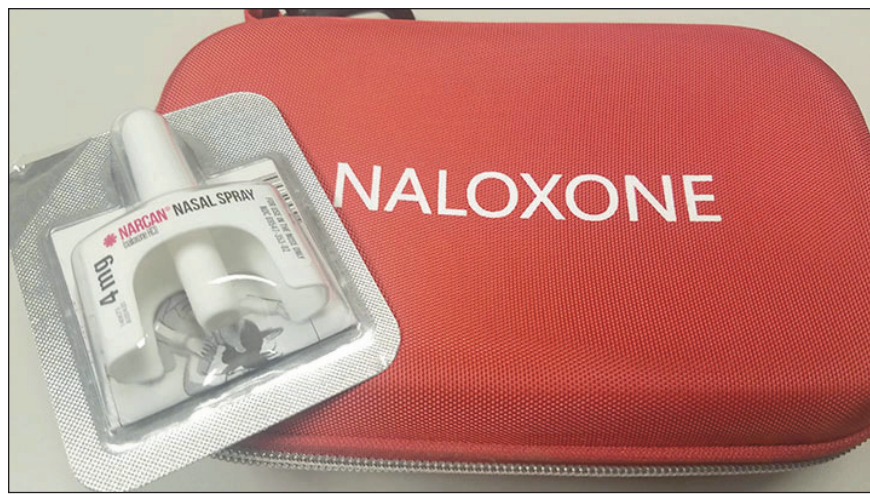

them."

So next time you see them out on the roads, remember that catching speeders and helping you change a flat tire aren't the only things that concern the Minnesota State Patrol. They're also working to keep Minnesotans safe from opioids. Making sure all troopers carry Narcan is, as Col. Langer puts it, "...a proactive move by the Minnesota State Patrol in the interest of trooper safety and

public safety."

You can avoid a ticket — and a crash — if you simply buckle up, drive at safe speeds, pay attention and always drive sober. Help us drive Minnesota Toward Zero Deaths.

If you have any questions concerning traffic-related laws or issues in Minnesota, send your questions by email to Sgt. Troy Christianson - Minnesota State Patrol at Troy.Christianson@state.mn.us.

E-mail: editor@star-herald.com Web site: star-herald.com
Phone: 507-283-2333 Fax: 507-283-2335

Published Thursdays by Tollefson Enterprises, POSTMASTER:
Send address changes to 117 West Main, P.O. Box 837, Luverne,
MN 56156. Periodicals postage paid at Luverne, Permit #33 and at
additional mailing offices.

General manager: Rick Peterson **News staff:**
Office manager: Deb Lusty Lori Sorenson, editor
Circulation manager: Jennifer Kor Mavis Fodness, reporter
Advertising: Chantel Connell John Rittenhouse, sports editor
Production manager: Abbe Kolar Esther Frakes, copy editor
Production: Heather Johnson

Rock County
STAR HERALD
Rock County's newspaper since 1873

(ISSN 0889-888X)
SUBSCRIPTION RATES

\$72 per year in Rock County; \$89 per year all other areas. Single copies \$1.25

Entire contents copyrighted by
Tollefson Publishing Roger Tollefson, publisher

The *Star Herald* encourages letters to the editor expressing the opinions of readers and intends to print all letters. Letters not meeting the guidelines will not be printed. The *Star Herald* will verify the authenticity of all letters. Letters must have the name of the writer, a signature and address.

Unsigned letters will not be considered. The *Star Herald* will edit for grammar, spelling and clarity. Any letters containing offensive language, libelous or slanderous material, or misleading or false information will be rewritten before being published. The *Star Herald* will not publish letters written with the sole intent to advertise or serve as a thank-you. Letters with more than 300 words may be edited. The deadline for letters is Monday 10 a.m. They may be delivered or mailed to the editor, *Rock County Star Herald*, P.O. Box 837, 117 W. Main St., Luverne, Minn. 56156.

ON THE RECORD

Dispatch report

April 6
 •Complainant reported yelling on Estey Street waking her up.
 •Complainant requested to speak with deputy about a personal matter.
 •Complainant reported someone is banging on the door of her house on Donaldson Street.
 •Complainant requested to speak with a deputy.
 •Complainant reported a single vehicle accident in Manley.
 •Complainant reported family and child issues.
 •Complainant reported getting harassing texts from suspect.
April 7
 •Complainant requested to speak with deputy via phone.
 •Complainant reported abandoned vehicle in Hills.
 •Complainant reported grass fire in Valley Springs.
 •Complainant reported a suspicious person on Donaldson Street.
 •Complainant reported a restraining order violated.
 •Complainant reported she thinks kids are transporting marijuana.
 •Complainant reported two trailers stolen from Magnolia.
 •Complainant reported drunk female being disorderly in Magnolia.
April 8
 •Complainant requested to speak to a deputy about someone wanting to drink at The Howling Dog.
 •Complainant on Walnut Ave reported her husband put his hands on her neck.
 •Complainant requested a motel voucher.
 •Complainant reported a two vehicle accident on Dodge Street.
 •Complainant reported roadside assistance in Magnolia.
 •Complainant reported vehicle for erratic driving.
 •Complainant requested assistance with guest on Kniss Ave.
April 9
 •Report of two vehicles parked outside on Donaldson Street for a long time.
 •Report of man knocking on door and requesting homeowner call police on Warren Street.
 •Complainant reported burglar alarm on Main Street.
 •Complainant reported accident in Valley Springs. Out of county. Transferred caller.
 •Complainant reported feed truck on fire on County Road 3.
 •Complainant requested Notice to Vacate to be served on Main Street.
 •Deputy requested vehicle on Warren Street towed.
 •Complainant reported a parked vehicle in Kenneth.
 •Complainant reported debris in the roadway in Beaver Creek.
 •Hospital requested deputy for patient reporting rape.
April 10
 •Request for welfare check.
 •Complainant attempted warrant service on 131st Street.
 •Deputy reported motorist assist in Kenneth.

•Complainant reported harassing communications in Magnolia.
 •Complainant reported car parked in Kenneth with someone sleeping inside.
 •Complainant reported a vehicle over the centerline into oncoming traffic on Highway 75.
 •Complainant reported theft on Warren Street.
 •Complainant requested escort to impound for vehicle release.
 •Complainant requested deputy come to his house to observe some possible property damage on Spring Street.
 •Complainant reported suspicious activity on Hatting Street.
 •Complainant requested welfare check on Estey Street.
 •Complainant on Oakley Street reported a harassing text.
 •Complainant reported he found a wallet on Main Street.
 •Complainant reported he kept getting an entry alarm from the pump house on 144th Ave.
April 11
 •Complainant conducted a warrant check on 131st Street.
 •Alarm company reported an activated alarm on Brown Street.
 •Train blocking the roadway in Jasper.
 •Complainant requested a welfare check on Estey Street.
 •Deputy conducted a roadside assist check in Manley.
 •Complainant reported smoke inside home in Beaver Creek.
 •Complainant reported subject entered business and requested they phone the police on Main Street.
April 12
 •Complainant requested deputies to remove someone from their house.
 •Deputy reported abandoned vehicle.
 •Complainant requested deputy for marijuana odor.
 •Complainant reported he is doing a follow-up in Magnolia.
 •Complainant reported threats to subject in Beaver Creek.
 •Deputy reported abandoned vehicle in Beaver Creek.
 •Complainant reported an accident in the parking lot on Kniss Ave.
 •Deputies completed warrant search on 131st Street.
 •Complainant requested to be fingerprinted.
 •Report of vandalism on Main Street.
 •Report of male on Freeman Ave who will not leave.

In addition, officers also responded to 1 transport, 7 escorts, 11 ambulance runs, 7 animal complaints, 14 burn permits, 2 drug court tests, 11 permit to purchase/carry applications, 60 traffic stops, 4 tests, 5 paper services, 2 background checks, 4 abandon 911 calls, 1 POR registration and 2 child maltreatment complaints.

Storm breaks snow records/continued from page 1A

two payloaders, a skid loader and a sidewalk snowblower and broom. But Stoffel said the April 14 event required 275 hours of work for the same part of town.

"I've never seen the snow settle on the sidewalks like that on the north side of the street," Stoffel said. "That was crazy."

Residents who ventured out Saturday night posted images of long, 4-foot-deep snowdrifts stretched across multiple storefronts.

The wind speed and direction made this blizzard unique, Stoffel said.

"We usually get winds out of the north for a snowstorm, but this one was northeast, so we had snow piled up in areas we haven't had before," he said. "The way the snow piled up downtown and in alleys... I've never seen that."

According to the National Weather Service, Sioux Falls received 13.7 inches on Saturday, which breaks the 1983 record on that day of 2.4 inches.

The single snowiest day in April was recorded in 1994 at 10.5 inches, which is far less than the new record of 13.7 inches.

The snowiest April on record in Sioux Falls was in 1983 with 18.4 inches. That record also fell with the 2018 storm that brings April's current snowfall total to nearly 25 inches.

The storm broke temperature records as well for the first half of April, according to the National Weather Service.

Marshall's average low temperature has been 25 degrees since April 1 (breaking the 1975 record of 30) and Sioux Falls average low temperature has been 30 degrees from April 1-15 with a previous record of 32.



Residents who ventured out Saturday night posted images of long, 4-foot-deep snowdrifts stretched across multiple storefronts. This image was shared by Luverne's Bronwyn Wenzel. "I've never seen the snow settle on the sidewalks like that on the north side of the street," Public Works Supervisor John Stoffel said. "That was crazy." Wind speed and direction made this blizzard unique, he said.

Prolonged winter weather delays planting

Kent Thiesse, Farm Management Analyst

Normally by mid-April area farmers have either begun spring fieldwork or are within days of the beginning of the planting season for the year. However, 2018 seems to be the "Winter that never ends," as another major snowstorm hit Minnesota and surrounding states this past weekend. Temperatures have been extremely cold during the first half of April, with soils still frozen in many locations. It appears that it could be May 1 or later before full-scale fieldwork begins in most areas of the region.

According to Minnesota state climatology data, the average temperatures in Minneapolis this year during the first 12 days of April have been the coldest since temperature records began in 1872. The 24-hour average temperature in 2018 during that time period was 27.5 degrees, colder than average temperatures of 28.2 degrees in 1920, 29.2 degrees in 1874, 29.4 degrees in 1975, or 32.1 degrees in 1939. During the first 12 days of April, there were over 120 new record low temperatures recorded at weather-reporting stations across Minnesota. In addition, following the snowstorm of April 13-15, many portions of the southern half of Minnesota have reached record or near-record snowfall amounts for the month of April, with more snow predicted for later this week.

Early corn planting in the Upper Midwest is usually one of the key factors to achieving optimum corn yields in a given year. Crop research by universities and private seed

companies indicates that the ideal planting date for corn in southern Minnesota and northern Iowa, when soil conditions are fit, is typically from April 15 to May 10. However, the ideal planting date for corn varies somewhat from year to year, depending on soil temperatures and soil conditions. Good corn yields can still be achieved when planting dates are extended into mid-May. For example, in 2017, following some early corn planting in mid-April, a significant amount of corn in southern Minnesota was planted during a period that extended into mid-May, which ended with a record statewide corn yield in 2017.

Crop consultants and agronomists are encouraging producers to be patient once the snow melts and the soils thaw before initiating fieldwork. Tilling fields too early can result in poor seedbeds and result in poor planting conditions, which can lead to crop emergence problems. Even though corn planting dates may be later than desired, it may be prudent to wait a few extra days to begin corn planting, in order to allow field conditions to reach more optimum levels. Research shows that 50 percent corn emergence will occur in 20 days at an average soil temperature of 50 degrees Fahrenheit, which is reduced to only 10 days with an average soil temperature of 60 degrees F. Hopefully, warmer soil temperatures in May will result in improved early season growing conditions.

Based on the March 1 USDA Planting Intentions, Minnesota crop producers were expected to plant 7.5 million acres of corn and 7.9 million acres of soybeans. Iowa farmers are

projected to plant 13.3 million acres of corn and 9.8 million acres of soybeans in 2018. Most farm operators will likely not switch intended 2018 corn acres to soybeans, unless corn planting dates get extended into late May or beyond. By April, producers typically have made arrangements for seed, fertilizer, and other crop inputs for the growing season, so they are likely to continue with their planned crop rotations.

2018 spring wheat acreage in the U.S. is projected at 47.6 million acres, which is an increase of 3 percent from the 2017 spring wheat acreage. Most of that increase would likely occur in North Dakota and northwest Minnesota. If the spring wheat planting dates are extended beyond May 1, some of those intended spring wheat acres may be switched to soybean acres for 2018.

One piece of good news for Upper Midwest farm operators is that many portions of the region are in reasonably good shape for stored soil moisture as we head into the 2018 growing season. There are some areas where conditions are a bit drier in western Minnesota and Iowa, as well as in North and South Dakota. Having adequate soil moisture for corn and soybean germination and early season growth should not be a problem this year in most areas of the Upper Midwest.

Historically, early planting of corn usually leads to higher than normal state average corn yields in Minnesota. In fact, in seven of the nine years that 50 percent or more of the state's corn acres have been planted in April, Minnesota has set a record corn yield. This included

Delayed planting/continued on 8A



Papik picks of the week...



2016 Cadillac SRX
 27K • Stock #531585Z
 Was \$28,990 Now \$26,990



2017 Ford Explorer
 24K • Stock #93199Z
 Was \$34,490 Now \$32,990



2017 GMC Acadia Denali
 14K • Stock #130071N
 Was \$35,990 Now \$33,990



2010 GMC Yukon XL
 184K • Stock #237927N
 Was \$15,990 Now \$10,490

283-9171

PAPIK.COM I-90 Luverne, MN 56156



Open wide



Lori Sorenson photos/0419 student dental screen

Caring Hands Dental screener Stacy Schueller, Alexandria, peers into fifth-grader Lucas Kelly's mouth Friday afternoon during a free dental screening of all Luverne Elementary students. High school students will be screened at a later date.

Elementary students receive free dental checks in effort to end poverty locally

By Lori Sorenson

Luverne Elementary School students opened their mouths Friday for a screening to determine if any of them need dental care.

A team of professionals with the non-profit Caring Hands Dental, Alexandria, met with students as part of an effort to identify children who may not have access to dental care.

"We have a lot of kids with dental problems," school nurse Phil Paquette said, adding that it can affect their concentration if a problem is painful.

All students (unless they opted out) watched a video about dental health, received individual 30-second

screenings, and left with a gift bag of oral health supplies.

The Caring Hands team noted which students may need a follow-up dental appointment and parents will be notified.

Those who don't have dental health insurance or access to a nearby participating provider can receive care through Caring Hands Dental.

This fall the team will return to perform more thorough exams on these students in a temporary 12-by-12-foot office with access to water at the school.

These exams will include X-rays and cleanings. If students are identified

as needing fillings or extractions, they'll be referred to the Alexandria Caring Hands office or another possible location.

There is no cost to the students or the district.

The high school students will be screened later this spring.

Dental care is one of five areas that Luverne's Leaders Partnering to End Poverty (LPEP) has identified as a barrier in the community.

Caring Hands Dental is part of a broader statewide initiative to improve oral health for all children. It receives funding through grants and donations to continue its work and mobile outreach.



Luverne school nurse Phil Paquette said dental care is important for student health and academic success. He's pictured here with items in a gift bag that each student was given after screening.

CELEBRATIONS

Open houses

An open house bridal shower for **Aimee Moss**, bride-to-be of **Brenton Richters**, will be at 10 a.m. Saturday, April 21, at the American Reformed Church in Luverne.

Jim Johanssen will celebrate his 75th birthday with an open house from 6-9 p.m. Friday, April 27, at the Luverne Eagles Club. Greetings may also be sent to him at 110 Walnut Street, Room 110, Luverne, MN 56156.

A come and go bridal shower for **Emily Lichtscheidl**, bride-to-be of **Nick Sandager**, will be from 10 a.m. to noon Saturday, April 28, at the Shirley Sandager residence at 331 31st Street in Hills.

A come and go bridal brunch for **Savannah Tinklenberg**, bride-to-be of **Brady Dinger**, will be from 10 a.m. to noon Saturday, April 28, at the Luverne Country Club, 1520 111th Street, Luverne.

Card showers

Lawrence Klooster will celebrate his 90th birthday on Wednesday, April 25. Greetings may be sent to him at 200 Oak Street, Luverne, MN 56156.

Lyle and Gloria Nelson will celebrate their 50th wedding anniversary on Friday, April 27. Greetings may be sent to them at 1209 North Linden Street, Luverne, MN 56156.

Ken Bowen will celebrate his 80th birthday on Friday, April 27. Greetings may be sent to him at 2419 180th Avenue, Edgerton, MN 56128.

MENU

Monday, April 23: Chicken hotdish, broccoli, lettuce with dressing, bread, tropical fruit.

Program: Pinochle.

Tuesday, April 24: Lemon pepper fish, baked potato with sour cream, creamed peas, bread, slice of pie.

Program: Half Price Day sponsored by Exchange State Bank. Senior Board Meeting.

Wednesday, April 25: Sweet and sour pork, rice, oriental vegetables, fruit, gelatin with whipped topping.

Thursday, April 26: Meatballs in gravy, mashed potatoes, beets, bread, angel food cake with fruit.

Program: Half Price Day. Game Day.

Friday, April 27: Baked chicken, potato salad, mixed vegetables, bread, apple.

Senior Dining offers well-balanced and affordable meals in a community atmosphere.

Gift certificates are available at the meal site or online at www.lssmn.org/nutrition.

Call Lauree Teunissen at 283-9846 to make dining reservations or for home-delivered meals.

REMEMBER WHEN

10 years ago (2008)

The lowhead dam on the Rock River near the Luverne City Park is unsafe for humans and for fish.

Those two factors have put it high on the state's priority list to fund its replacement through the safety and ecology funds.

At the Luverne City Council's Committee of the Whole meeting Tuesday, John Call reported that funding for the \$364,000 project has been secured.

"I think we're going to have plenty of money to do the project, and it will require very little out-of-pocket funding for the city of Luverne," Call said.

25 years ago (1993)

U.S. Sen. Paul Wellstone (D-Minn.) announced that five Minnesota counties have been named by Agriculture Secretary Mike Espy as eligible for Farmers Home Administration emergency loans. The counties are eligible as a result of crop damage from severe weather conditions occurring from June through November 1992.

"This is excellent news for a part of the state that has seen some extreme weather the past few years," said Wellstone. "The loans will help a number of families avert serious hardship. The Department of Agriculture named Nobles County as the primary county for the emergency loans, with four additional counties named because they are contiguous to Nobles. These additional counties are Cottonwood, Jackson, Murray and Rock.

Farmers in all five counties have eight months to apply for the loans to help cover part of their actual losses. To be eligible, they must have suffered 30-percent loss of normal production. Farmers must also be able to repay the loans and any other loans, be unable to get credit elsewhere and have adequate security.

50 years ago (1968)

Thirty-nine men and women employed by Northwestern Bell Telephone Company here will go on strike at 2 p.m. today, unless a settlement is reached before then between the company and the Communication Workers of America union.

At last report, just before press time, there was no possible solution to the dispute in sight.

When the deadline arrives, and a settlement has not been reached, it will mean all employees except management and supervisory personnel will walk out, according to Bryan Eichenwald, local Northwestern Bell manager. ...

Every effort will be made to keep telephones

served by the exchange in service. Priority, however, will be given to emergency type phones such as police department, fire department, hospital, sheriff's office, and similar services vital to the health and welfare of the community, Eichenwald said. As far as placing local calls is concerned, there will be no problem, said Eichenwald, as no manual assistance is required in the making of local calls. However, long distance calls may be affected as far as speed in making them is concerned, because of lack of long distance operators.

75 years ago (1943)

Luverne firemen will tell you that the old adage, "where there's smoke, there's fire" doesn't hold true in every case.

About 11 p.m. Sunday, the local fire department was summoned to make one of the shortest runs in history, to the Hinky building almost directly across the street from the fire station. It was about bus time, and Mrs. I.N. Johnson who stepped out of the bus depot noticed what appeared to be smoke coming from the building. She informed Officer Kennedy who turned in the alarm, and it was only a matter of minutes before the firemen had hoses laid ready to pour water on the blaze.

Gray clouds of vapor, seeping through virtually every crack and opening in the building had the firemen stumped for a few moments, as to where the fire was burning. On breaking a window in the building, however, it was discovered that it was steam, not smoke, coming out, and a rush call to the city power plant soon had the heat main "cut out."

After several minutes, the "smoke" lifted, and an investigation revealed that a pipe in the basement vault, underneath the sidewalk, had broken, causing steam to escape.

100 years ago (1918)

Three automobiles, two of them owned by Iowa parties whose names are not known, and the third one said to be the property of John Meints, of this city, were quite thoroughly daubed up with yellow paint Tuesday evening as they were standing on the streets at Hardwick while the occupants were attending a Nonpartisan meeting being held there.

The two Iowa cars are said to have been used to convey members of the league from Lyon county and the speaker to Hardwick, while the Meints car is said to have furnished several local members and sympathizers of the league with means of attending the gathering.



1952: St. Catherine's breaks ground for new convent in Luverne

The following appeared in the Rock County Star Herald on June 5, 1952.

Breaking Ground For The New Convent at St. Catherine's church here took place Monday morning. Rev. M.L. Doyle is shown turning the first spadeful of sod, preparatory to the new two-story brick building. Members of the building committee, shown left to right in the photograph, are Cyril Deiterman, C. Busch, Rudolph Hassler, H. L. Smith, William Wiggins and H. L. Far. The building will have eight bedrooms, a chapel, two parlors, two classrooms, and a combined kitchen, dining room and living room.

Donations to the Rock County Historical Society can be sent to the Rock County Historical Society, 312 E. Main Street, Luverne, MN 56156.



Bits by Betty

By Betty Mann, president Rock County Historical Society

Mann welcomes correspondence sent to manned@iw.net.

OBITUARIES

Jacob Gonnerman

Jacob Tyler Gonnerman, 28, Luverne, died Saturday, April 14, 2018, at the Sanford Luverne Medical Center.

A funeral service will be at 10:30 a.m. Friday, April 20, at Grace Lutheran Church in Luverne. Burial will be in the Maplewood Cemetery in Luverne. Visitation will be from 4-8 p.m. Thursday, April 19, at the church and also one hour prior to the service on Friday.

Jacob Gonnerman was born Nov. 20, 1989, to Ronald and Mary Lou (Saukerson) Gonnerman in Luverne. He attended school in Luverne and later attended Ellsworth High School.

Jake married Courtney Dreesen on Oct. 17, 2015, in Brandon, South Dakota. The couple lived in Luverne. Jake worked near Ellsworth as a farmhand for Daniel and Harlan DeBeer before he began as a welder at Virg's Welding in Sioux Falls, South Dakota. He also owned and operated J & N Power Washing in Luverne.

He was a member of Grace Lutheran Church in Luverne. Jake was an avid fisherman and hunter. He



enjoyed darts and outdoor activities with his wife, children and nephew Brody.

Jake is survived by his wife, Courtney Gonnerman, Luverne; a daughter, Amelia, and a son, Wesson; his parents, Ronald and Mary Lou Gonnerman, Luverne; two sisters, Trisha (Brad) Goebel, Luverne, and Sara (John) Bennetts, Sioux Falls; his father- and mother-in-law, Kevin and Glenda Dreesen, Ellsworth; a brother-in-law, Glen Dreesen, Ellsworth; his grandparents-in-law Orvel and Karen Dreesen, Ellsworth, and Jan Tiesler, Little Rock, Iowa; and his nieces and nephews, Jamie Bennetts and Brody, Rylin, Liam and Azley Goebel.

He was preceded in death by his grandparents, LeRoy and Harriet Gonnerman, Wilbur and Eleanor Saukerson and Glen and Gayla Tiesler.

Jake's final act of kindness was to give the gift of life through organ and tissue donation.

Arrangements are provided by Dingmann Funeral Home of Luverne, www.dingmannandsons.com.

(0419 F)

Vance Ebert

Vance Ebert, 94, Luverne, died Monday, April 9, 2018, at the Minnesota Veterans Home in Luverne.

A memorial Mass will be at 11 a.m. Saturday, April 28, at St. Catherine Catholic Church in Luverne. A time of fellowship will be one hour prior to the service at the church. Burial of cremains with full military honors provided by the Luverne American Legion and VFW will be at St. Catherine Cemetery.

Vance Ebert was on Feb. 17, 1924, to Charles W. and Maude (Isabelle Moody) Ebert in Worthington. In 1926 the family moved to a farm near Clear Lake, South Dakota, where Vance attended school, graduating in 1942. After high school he worked on the family farm and at the Watertown air base in construction before being inducted into the Navy in 1945. Vance served on active duty for 10 months and as a member of the Naval Reserve for four years.

Vance married Doris "Tootie" Warner on Feb. 17, 1947. They moved their family to Luverne in December 1955 where Vance was the manager of the Luverne Farmers Elevator, a position he would hold for more than 33 years. In addition to their own children, Vance and Doris were parents to five foster children over the years. Following his retirement from the elevator, Vance was a campground host at Blue Mounds State Park and also spent many years working at Papik Motors.

Vance was a member of St. Catherine Catholic Church and served on many boards including Land O' Lakes for 17 years, Luverne City



Council for 13 years, Chamber Council, the Regional Rail Authority, St. Catherine's Building Committee, the Regional Development Commission, and the Private Industry Council.

Some of Vance's fondest memories include being invited to the top of Mount Rushmore for observation of its construction in 1942, attending the World's Fair in New York in 1964, and participating in the People to People tour of Denmark, Sweden, Norway, Finland, Russia, and Germany in 1972. Vance will always be remembered for his quiet demeanor, strong wit and sense of humor.

Vance is survived by his daughter-in-law Terri Ebert of Luverne; two sons, Jim (Mary) Ebert, Truman, and Paul (Dyan) Ebert, Big Lake; six grandchildren, Katie (Matt) Mostad, Sarah (Paul) Zebe, and Amanda (Eric) Lammert, all of Luverne, Jessica (Ethan) Harvey, Wrenshall, Jake (Nicole) Ebert, Truman, and Laurin Ebert, Big Lake; and 10 great-grandchildren, Jordyn Harvey, Peyton Franzen, Riley Harvey, Charlie Mostad, Ingrid Mostad, Daphne Zebe, Gage Zebe, Tatum Zebe, Alex Ebert, and Reese Ebert.

He was preceded in death by his parents; his wife, Doris, on June 26, 2016; his son Chuck on June 14, 2002; and his siblings.

The family would like to thank the employees of the Minnesota Veterans Home for 16 years of excellent care for Vance.

Arrangements are provided by Dingmann Funeral Home of Luverne, www.dingmannandsons.com.

(0419 F)

LHS sends four to state speech tournament

Adrian students also competing in Friday-Saturday event

By Mavis Fodness

Sophomore Alexia Chesley admits she feels nervous about qualifying for Friday and Saturday's Minnesota State High School Speech Tournament in Apple Valley.

"It's a relief to be going," she said Monday. "I hope I can do the best I can."

The first-time state qualifier is keeping a Luverne High School tradition going in the discussion category. For the past eight years, LHS

has had at least one state qualifier in discussion.

Junior Shane Berning and eighth-grader Chance Tunnissen, however, are upping the standard in extemporaneous speaking by both qualifying for the state competition. Luverne has had at least one state qualifier in extemp speaking in the past five years.

In his fourth year on the speech team, Berning said participants in the category have increased to 11 or 12 at the section meet.

"It's been a really big year for numbers," Berning said.

The Friday-Saturday competition is Berning's

second trip to the state competition. He earned a trip in 2016 as a freshman in the same category.

Since his last state appearance, Berning has learned a secret to competing well at the weekly meets.

"If you don't sound confident, you're not going to win," he said.

That confidence has been passed on to Tunnissen who is using the state competition to expand his knowledge in extemp speaking.

"Since it's my first time, I want to use it as a learning experience to see what other speakers are doing," he said.

Sophomore Nicole

Hoogland followed in her older sister Hannah's footsteps by competing in extemporaneous reading.

This is Hoogland's first time competing at the state tournament. She is keeping the same goal she set for herself at the beginning of this year's speech season.

"My goal was to try the best I can," she said.

Two Adrian students also attending state meet

AHS junior Sabdi Bravo returns to the state speech competition in informative speaking. Last year Bravo earned a sixth-place medal.

Sophomore Maritza Beltran competes for the first time in poetry.

Luverne speech team places eight in section finals

Seventeen Luverne High School speech team members competed in the Section 3A speech tournament Thursday, April 12, at Tracy.

The event was moved up two days from Saturday, April 14, due to extreme weather forecasts.

Section 3A competition included schools in sub-sections 10, 11 and 12.

The top three speakers in each of the 13 speech categories move on to the state competition Friday and Saturday, April 20-21, in Apple Valley.

Eight Luverne participants broke into the final section round, and of those, four will be heading to state. (See related story.)

Earning a state trip are Chance Tunnissen and Shane Berning, who took second and third respectively in extemp speaking; Alexia Chesley, third in discussion; and Nicole Hoogland, second in extemp reading.

Students receiving medals but not moving on to state competition were Xavier Carbonneau, fifth, storytelling; Gunnar Oldre, fifth, humorous; Luke Thorson, sixth, humorous; and Jonah Louwagie, sixth, storytelling.

Co-coach Caroline Thorson reflected on the recently completed speech season.

"Coach (Gavin) Folkestad



Submitted photo

Eight Luverne High School students earned medals at the section speech tournament April 12 in Tracy. Pictured (front, left) are Nicole Hoogland, Luke Thorson, Xavier Carbonneau, Alexia Chesley, (back) Chance Tunnissen, Shane Berning, Gunnar Oldre and Jonah Louwagie.

and I were thrilled to see so many kids make it to the final round since competition is fierce," she said. "We know not everyone can go on, and not advancing does not diminish the pride we feel for all our speakers on the team."

Team captains Julia

Ferguson, Shane Berning, and Lindsey Roemeling addressed the team before section competition began in Tracy.

Ferguson reminded the team that qualifying for sections was a great accomplishment and they should feel proud to be among this

group no matter the outcome of the night.

Roemeling reminded the team that this was not the end for any of them.

"The team is not losing any seniors so we are looking forward to a great season next year too," Thorson said.

Eight Adrian students compete at section speech meet

Six out of eight Adrian High School students earned medals in the Thursday, April 12, Section 3A Speech Tournament in Tracy.

Two students move on to this weekend's state competition.

At the section meet, sophomore Maritza Beltran and junior Sabdi Bravo qualified for the state tournament.

Students had to place first-through third to move on to the state.

Beltran finished second in poetry and Bravo was third in informative speaking.

This is Bravo's second trip to a state tournament. She earned a sixth place medal in informative speaking last year.

Other medal winners included Sara Knips, sixth, prose; Jayda Castaway, sixth, original oratory; Alexia Kemper, sixth, extemporaneous reading; and Felicity Alvarado, fifth, great speeches.

Tristan Thier participated in discussion and Emma Fuerstenberg in humorous.



Submitted photo

Eight Adrian High School students participated in last week's Section 3A Speech Tournament in Tracy. Pictured from left are Tristan Thier, Sabdi Bravo, Sara Knips, Emma Fuerstenberg, Jayda Castaway, Maritza Beltran, Alexia Kemper and Felicity Alvarado.

DEATH NOTICES

Rhett Boltjes

Rhett Gerald Boltjes, infant son of Jonas and Sara (Schipper) Boltjes, Lismore, died Monday, April 9, 2018, at the Sanford USD Medical Center in Sioux Falls, South Dakota.

A funeral service was Monday, April 16, at St. Adrian Catholic Church in Adrian. A private burial will take place at a later date at St. Adrian Cemetery.

Arrangements were provided by Dingmann Funeral Home of Adrian, www.dingmannandsons.com.

(0419 DN)

Charles 'Cub' Holm

Charles "Cub" Holm, 86, Luverne, died Monday, April 16, 2018, at the Minnesota Veterans Home in Luverne.

A memorial service will be at 2 p.m. Friday, April 20, at the Dingmann Funeral Home in Luverne. Burial of cremains with full military honors provided by the Luverne American Legion and VFW will be in the Maplewood Cemetery in Luverne. A time of fellowship will be from 4-6 p.m. Thursday, April 19, and also one hour prior to the service Friday at Dingmann Funeral Home.

Arrangements are provided by Dingmann Funeral Home of Luverne, www.dingmannandsons.com.

(0419 DN)

CITY OF HARDWICK ASSESSMENT NOTICE

The Board of Appeal and Equalization for **Hardwick**, will meet at **7:00 PM on Wednesday, the 2nd day of May, 2018**, at the **Hardwick City Hall**. The purpose of this meeting is to determine whether property in the jurisdiction has been properly valued and classified by the assessor.

If you believe the value or classification is incorrect, please contact the assessor's office to discuss your concerns. If you disagree with the valuation or classification after discussing it with your assessor, you may appear before the local board of appeal and equalization. The board will review your assessments and make corrections as needed. Generally, you must appeal to the local board before appealing to the County Board of Appeal and Equalization.

Given under my hand this 14th day of February, 2018.

Tammy J. Johnson, Hardwick City Clerk

ROCK COUNTY VETERANS



Did you serve on Active Military Duty?

Do you have an honorable discharge?

Contact your veteran services officer to discuss eligibility for federal and state benefits.

Veterans Linkage Line
minnesotaveteran.org | 1-888-LinkVet (546-5838)

Help for veterans and families

Rock County Veterans Services

507-283-5061
M-F: 8 a.m. to Noon
Rock County Courthouse

Roads closed in southwest Minnesota due to zero visibility and deep snow/continued from page 1A

electricity, Verbrugge said local officials activated their own emergency response team.

This included city, county, utilities, fire departments and public works leaders to be in contact with each other in case an emergency response was needed.

Verbrugge said the ambulance was dispatched to a medical emergency in Hardwick, and that required a snowplow to clear a path.

"We encountered 4-foot drifts, so you're limited in what you can do with regular vehicles," Verbrugge said.

He credited the Rock County Highway Department, Minnesota Department of Transportation, public utilities crews, local fire departments, tow truck drivers and the State Patrol for working together on public safety.

"I can't say enough about these resources that were utilized," Verbrugge said.

State Patrol response

Lt. Matt Sorenson with the Minnesota State Patrol said the road closures and their early anticipation helped to keep motorists — and potential emergency personnel — out of harm's way.

"The numbers of incidents weren't as bad as they could have been, because roads were closed early enough and people had ample warning ahead of the snow," said Sorenson, who lives in Rock County and has worked Marshall District of the State Patrol for 27 years.

He said the storm broke the record in terms of snowfall

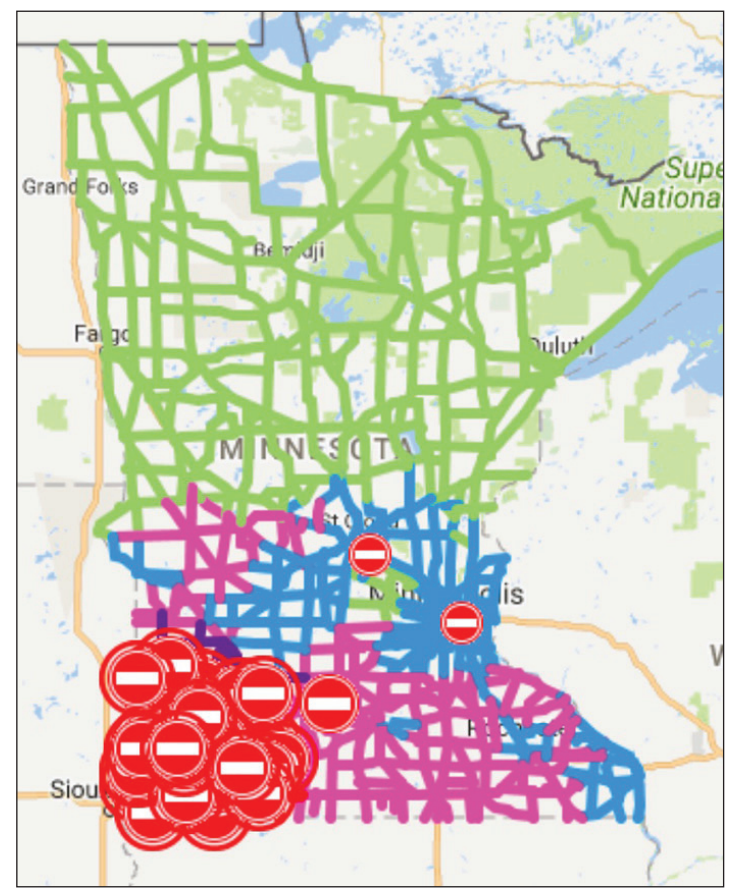

Completely Covered Travel Not Advised Closure

The arduous task of clearing Minnesota roads began Sunday as seen in the photo at left taken in the northern part of the Marshall District. Above is a screen shot of the MN 511 application taken Saturday afternoon showing roads closed.

amounts, but he said this one resulted in fewer crashes and injuries.

"We've had two- to three-day blizzards before, but it helped that this one was slow moving, which gave people time to prepare," he said.

"It hit in South Dakota first, and their roads were closed,

so we didn't have traffic coming from that direction."

Most of the crashes and vehicles off the road happened in the northern part of the Marshall District.

He said several Troopers had trouble getting stuck multiple times while responding to incidents, and

some weren't able to get home at the end of their shifts.

What's unique about April storms, Sorenson said, is that they're usually more debilitating in terms of travel.

"It's a wet snow that packs on the road more quickly," he said. "DOT can't push it off as fast, and the shoulders are soft,

so they can't wing it out as far."

Sorenson said Sunday was actually his busiest day of the weekend, because the roads opened to travel, but they were still covered with ice, snow and slush, causing accidents.

As with all winter driving, he said motorists should always be prepared with a

survival kit of food, water, a charging cord for cell phones and extra clothing or blankets.

"We did have one motorist in the northern part of our district who spent the night in his vehicle," Sorenson said.

"We just couldn't get to him, even when working with snowplows."



In zero visibility, this pickup driver didn't see the car that had been abandoned on the side of the road in the blizzard. The photo at left was taken Sunday during road cleanup. In the photo at right, another car is recovered from a deep snowbank on a roadway in the northern part of the area affected by the weekend blizzard that dropped more than a foot of snow. (submitted photos)

POSTPONED see dates below

Luverne

Love the life!

SPRING CLEAN UP

PLEASE TAKE NOTE

REFUSE & RECYCLING PICK-UP REMAINS THE SAME
Please set garbage & recycling separate from junk!
Very large unsorted piles of junk will NOT be picked up

Crews may work ahead of schedule, but will return to each route on the scheduled day to pick up remaining items.

BRANCH PICK UP - STARTING MONDAY, APRIL 30 - Throughout the week

PICK-UP SCHEDULE

Route 1: Main St. and to the South
Monday, April 30

Route 2: Main St. to Dodge St.
Tuesday, May 1

Route 3: Dodge St. to Barck & Tri-State Addition
Wednesday, May 2

Route 4: Barck and to the North
Thursday, May 3

What will NOT BE PICKED UP

Tires, toxic or hazardous chemicals, TV's, electronics, computers, VCR's, stereos, cameras, camcorders, cell phones, game decks, mattresses, car batteries, fluorescent light tubes, waste oils, paints, and household hazardous waste will NOT be picked up and should be disposed of properly. Very large unsorted piles will NOT be picked up. Additionally, large quantities of building materials from construction or remodeling should be disposed of as part of your project and will not be picked up by the City during Spring Clean-Up. It is your responsibility to take these items to the Transfer Station. The Rock County Transfer Station is located ¾ mile East of Luverne on Rock County Road 4, and ¾ mile North on Rock County Road 9.

Delayed planting/from page 5A

the record corn yields of 194 bushels per acre in 2017, 193 bushels per acre in 2016 and 188 bushels per acre in 2015. In 2017, after some favorable planting conditions during the third week of April, the state's corn planting percentage was at 57 percent on April 30. The corn planting completion rate in Minnesota reached 85 percent by May 7. Given the current field conditions and winter weather conditions in mid-April, it may be difficult to achieve the strong corn yield levels of the past three years in 2018, unless field conditions in the state improve dramatically in the next few weeks.

Most Upper Midwest crop producers are facing very tight profit margins in 2018. Any significant reductions in crop yields for the year below the projected yields for a given farm operation, unless there are improved crop prices, will cause major financial issues for many farm operations by the end of the year. Improved spring planting conditions in the next 4-5 weeks will be critical to crop yields and crop profitability in 2018 for Upper Midwest farm operators.

24/7 ... Rain or Shine ...

Your local, independent agent will be there.

Working for you - meeting your needs.

Buffalo Ridge INSURANCE

South Hwy. 75, Luverne, MN • Ph. 507-283-2381

Auto-Owners INSURANCE

LIFE • HOME • CAR • BUSINESS

Notice To All Bidders

Springwater Township is accepting bids for mowing the township hall and the cemetery. Bids should be per mowing. Bidder will furnish their own equipment and fuel. The Township board reserves the right to reject any and all bids.

A certificate of insurance MUST ACCOMPANY all bids!
Please contact a board member or e-mail springwater@alliancecom.net, concerning insurance liability limits.

Bids must be submitted before Tuesday, May 1st, 2018 to:

Teresa Kramer, Clerk
137 131st St.
Garretson, SD 57030

or presented at the township board meeting that evening at the home of the clerk.

Teresa Kramer
Springwater Township Clerk



Architect renderings courtesy of JLG Architects

In this new architectural rendering of Luverne Middle-High School's front entrance about 6,500 square feet was removed from the new Community Education/Family U addition. As a cost-saving measure, architects recommended moving the school's media center to the second floor allowing Community Education/Family U to move into existing space.

School construction project reaches final design

Education officials approve building new construction, remodel, refresh plan in special meeting

By Mavis Fodness

Luverne's \$30 million school renovation and improvement project moved to the next phase when board members unanimously approved the architect's design development plans in a special April 12 meeting.

A 35-minute presentation by JLG Architect's Lynn Remmers highlighted changes and decisions made since the board approved the project's schematic design in February.

Also at the presentation were JLG's Katie Becker and ICS Consulting's Joel Bornhoft and Todd Wetzal.

The two-month design development phase had architects and school staff determining furnishings and putting final dollar estimates to the project.

Remmers said two floor plan changes were made to tighten the budget as well to meet educational needs.

"It's been a real team effort," she said.

The changes involved moving the middle-high school media center from the first floor near the new commons area to the second floor, above the school's main entrance.

The media center's new location is near the second-story classrooms. Remmers said the move saved \$660,000.

"We think it will be a real cool design feature," she said.

Removal of the media center from the first floor plan reduced the Community Education/Family U addition by 6,500 square feet.



© 2018 JLG ARCHITECT

A conceptual view from the northeast corner of the new middle-high school cafeteria-commons shows windows facing out to Dodge Street with the building's new main entrance located to the far left. The performing arts center entrance is located off to the right.

Architect renderings courtesy of JLG Architects

Remmers said no classroom or programming spaces were lost in tucking the program more into the

existing school structure. With the approval of the design development, the project moves to

the construction document phase, which is expected to take about three months.

The 15-month construction phase is expected to begin this fall with completion in late 2019.

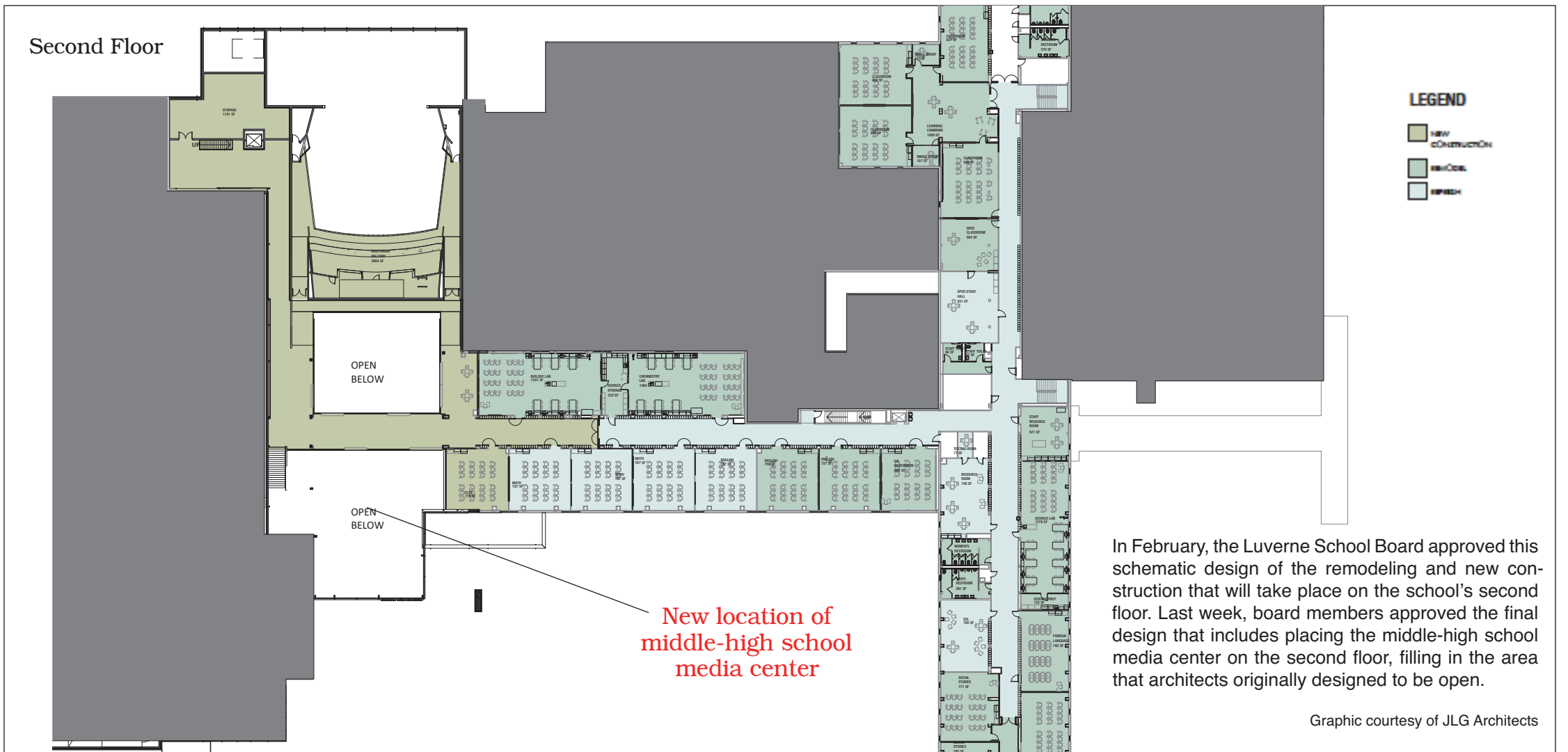

In February, the Luverne School Board approved this schematic design of the remodeling and new construction that will take place on the school's second floor. Last week, board members approved the final design that includes placing the middle-high school media center on the second floor, filling in the area that architects originally designed to be open.

Graphic courtesy of JLG Architects

Tennis team wins home opener against Vermillion

By John Rittenhouse

The Luverne Cardinal tennis team picked up its first win of the 2018 season during an abbreviated home debut Thursday.

Luverne entertained a short-handed squad from Vermillion, South Dakota, to open its home slate.

With Vermillion having just four varsity players available for the match, LHS received forfeits for all three doubles slots in its lineup.

When the Cardinals swept Vermillion in singles competition, a 7-0 victory was complete.

"They only have four players so we played all the singles matches and they had to forfeit all the doubles matches," said LHS coach Greg Antoine.

"We have a lot of experi-

ence with the four singles players we played. They have taken turns beating each other in practice, so it will be difficult to determine a true singles lineup. We'll be strong in all four singles positions regardless of who plays where."

Luverne won all four singles matches in straight sets.

Mark Robinson secured 6-2 and 6-1 conquests over Emile Kahn at No. 1, while Cade Ver Steeg notched a pair of 6-0 wins against Liam Mechling at No. 2.

Jim Erickson saddled Nic Harris with 6-1 and 6-0 setbacks at No. 3, and Trey Baustian topped Ramiro LaFuente by 6-1 and 6-2 tallies at No. 4.

The win left LHS with a 1-3 record.



John Rittenhouse photo/0419 tennis 3

Senior Mark Robinson strikes a forehand during Thursday's home win over Vermillion, South Dakota.



John Rittenhouse photo/0419 lgt 5

Luverne's Sydney Bieber takes the baton from Gracie Zewiske during the 800-meter relay at the Cardinal Relays in Luverne Thursday. LHS won the event and captured the team championship during the season's first meet.

LHS girls win Cardinal Relays with 174-point performance

By John Rittenhouse

The Luverne girls' track team opened the 2018 season in style Thursday in Luverne.

The LHS girls played the role of hosts for nine other teams during the annual Cardinal Relays.

Luverne compiled 174 points to easily outscore second-place Pipestone (101 points) and the rest of the field to capture the team championship.

The Cardinals won seven event titles and placed second in five events to highlight their dominating performance.

Brooklyn Ver Steeg had a big day for the hosts by winning two individual events

and running a leg with a pair of championship-earning relay teams.

Ver Steeg cleared 4-10 to win the high jump and produced the winning time of 1:03.15 in the 400-meter dash.

Ver Steeg joined forces with Regan Feit, Tenley Nelson and Gabrielle Ferrell to win the 1,600- and 3,200-meter relays with respective 4:24.3 and 10:27.86 times.

Nelson also landed a meet championship by winning the 1,600-meter run with a time of 5:42.

Luverne also fielded the winning 400- and 800-meter relays.

Mallory Oye, Sydney Bieber,

Ivy Hudson and Gracie Zewiske claimed the 400-meter title with a time of 54.05.

Savannah Siebenahler, Zewiske, Bieber and Hudson claimed the 800-meter crown in 1:55.49.

Luverne's Mallory Thorson recorded a pair of second-place finishes with distances of 15-2 in the long jump and 32-10 in the triple jump.

Bieber and Feit placed second in the 200-meter dash and the 800-meter run with respective 28.4 and 2:39.81 efforts.

Cassie Flanagan made a bid to win the 3,200-meter run before placing second with a time of 13:32.19.

Here is a look at the rest of

Luverne's point-producing efforts during the Cardinal Relays.

Third place: Hudson, 100, 13.51; Mackenzie Petersen, high jump, 4-6.
Fourth place: Oye, 200, 30.1; Siebenahler, 300 hurdles, 56.97; Autumn Nath, high jump, 4-6; Siebenahler, triple jump, 30-5 1/2.
Fifth place: Ferrell, 1,600, 6:19.41; Feit, pole vault, 6-6.
Sixth place: Tiana Lais, 200, 30.19; Tia Hadler, shot, 29-2; Nelson, pole vault, 6-6; Zewiske, long jump, 14-2; 800 relay (Alyssa Nattress, Meghan Mollberg, Hailey Kruse and Petersen), 2:02.99; 3,200 relay (Flanagan, Elizabeth Wagner, Kamryn Van Batavia and Madison Reisdorfer), 11:48.45.
Seventh place: Lauren Ver Steeg, 300 hurdles, 1:01.02; Lais, long jump, 14-1 1/2.
Eighth place: Mollberg, 100, 14.39; Wagner, 1,600, 6:28.53; Brooke Feit, shot 27-8 1/2; Ferrell, long jump, 14-1 1/2.

Boys place fifth in 10-team field during home meet

By John Rittenhouse

The Luverne Cardinal boys made their 2018 track debut at home Thursday when they hosted the annual Cardinal Relays.

The meet was staged under cool and cloudy conditions for the 10 teams on hand for the event.

Luverne's boys placed fifth in the field with 73 points.

Worthington took top honors as a team with 158 points.

The Cardinals finished the event with one meet championship and one second-place performance.

Jed Dooyema, who placed sixth in the 200-meter dash in 25.45, won the pole vault crown after clearing 12-0.

Matt Ziegler, who placed third in the shot put with a distance of 39-8 1/4, placed second in the discus with a toss covering 115-8.

LHS also received two other third-place efforts during the meet.

Dalton DeSollar finished third in the 1,600-meter run with a time of 5:10.2.

DeSollar also ran a leg with



John Rittenhouse photo/0419 lbt 8

Luverne's Eli Haugom placed sixth in the high jump during the Cardinal Relays Thursday.

Luverne's 3,200-meter relay, which finished third in 9:24.79.

Austin Winter, Brayden Tofteland and Michael Rahm teamed up with DeSollar in the 3,200 relay.

Here is a look at the rest of

Luverne's point-earning efforts during Thursday's meet.

Fourth place: Tofteland, 3,200, 11:40.78.
Fifth place: Winter, 800, 2:18.55; Brogan Hart, shot, 38-3 1/2; 1,600 relay (Jordy Thone, Ashton Sandbulte, Abraham Hernandez and Dooyema), 3:58.84.
Sixth place: Eli Haugom, high jump,

5-6; 3,200 relay (Jonah Friedrichsen, Brady Bork, Griffin Ahrendt and Ethan Curtiss), 10:43.25.
Seventh place: Ashton Sandbulte, 100, 12.29; Friedrichsen, 3,200, 12:05.72; Zach Ahrendt, shot, 37-5 1/2; Kameron Keene, discus, 99-7.
Eighth place: 800 relay (Thone, Sandbulte, Nick Rogers and Dooyema), 1:50.

Patriot track squads open season in Luverne

By John Rittenhouse

The Hills-Beaver Creek track squads made their 2018 debuts at the Cardinal Relays in Luverne Thursday.

H-BC was one of 10 schools making appearances at the meet.

The Patriot athletes won a combined three meet championships and placed second in one event to highlight their showing in Luverne.

Kourtney Rozeboom won a pair of meet titles to lead the H-BC girls to a sixth-place performance as a team.

H-BC scored 58 points in a nine-team field led by Luverne, which compiled 174 points.

Rozeboom claimed the

shot put and discus titles with respective 39-4 1/2 and 89-2 1/2 tosses.

The H-BC girls also placed second in the 800-meter relay with a time of 1:55.49.

Madison Spath, Kenadie Fick, Sidney Fick and Taryn Rauk formed the team.

The H-BC boys placed ninth in a 10-team field with 29 points.

Worthington walked away with the team championship by scoring 158 points.

H-BC captured the title of the 400-meter relay with a time of 47.64.

Hunter Bork, Luke LaRock,

Open/continued on page 3B

Luverne baseball team bests Adrian Thursday

By John Rittenhouse

Two baseball teams from the Star Herald coverage area opened the 2018 season by playing against each other Thursday in Adrian.

The Luverne Cardinals and Adrian Dragons made up a game that was originally set for March 29.

The visiting Cardinals stole the show by registering a 9-0 victory.

Luverne, which registered a combined shutout from four different pitchers, scored all nine of its runs in the final four

innings of the game.

LHS opened a 3-0 lead when Declan Beers belted a two-run home run and Charlie Reisch delivered an RBI single in the fourth inning.

Ben Serie doubled and scored on an error to make it 4-0 in the fifth inning, and the Cards scored two more runs in the sixth inning when Tyler Reisdorfer slapped a two-run double.

Luverne capped the scoring with a three-run seventh inning.

Reisdorfer capped a three-

RBI effort with a fielder's choice, Dylan Mente singled home one run and Mark Sterrett walked and scored on a passed ball during the seventh-inning rally.

Derek Lundgren tossed two hitless innings as Luverne's starting pitcher before giving way to Jake Haugen, who worked the next two frames and received the win.

Ben Serie pitched the fifth and sixth innings and Reisdorfer tossed the seventh inning.

Skylar Polzine took the loss for Adrian after tossing four-

plus innings of three-run ball.

Lance Luettel also pitched for the Dragons.

Adrian received one hit each from Brent Hokeness, Jeffery Cauwels and Noah Reyne.

Box score	AB	R	H	BI
Reisdorfer	4	0	1	3
Serie	4	2	2	0
Beers	3	1	2	2
Haugen	3	1	0	0
Lundgren	4	0	2	0
Reisch	3	1	1	1
Sterrett	3	1	1	0
Smith	1	0	0	0
Bartels	3	1	1	0
Mente	3	2	2	1



John Rittenhouse photo/0419 hbc track 5

H-BC junior Sidney Fick prepares to receive the hbc track 5 from her sister, Kenadie Fick, during Thursday's Cardinal Relays.

Bus tragedy casts shadow over fine hockey season

Luverne's Chaz Smedsrud had a solid hockey season as a member of the Notre Dame Hounds.



Smedsrud, a 2016 Luverne High School graduate, displayed obvious improvement during his second season with the team, which competes in the 12-team Saskatchewan Junior Hockey League.

The former LHS stand-out turned in a 61-point season, the league's 11th most productive offensive performance during the 2017-18 campaign.

He led his team and finished seventh overall in the league with 29 goals during a 58-game regular season.

The Hounds, a team based in Wilcox, Saskatchewan, bowed out of the league playoffs at the end of the opening round, but not without Smedsrud turning in a memorable showing by scoring three goals and registering three assists (four assists in a three-game series) in Notre Dame's lone post-season win last month.

After producing 33 points during 45 games as a member of the team during the 2016-17 season, Smedsrud nearly doubled his point production during his second season in Canada.

"I'm happy with the year I had," said Smedsrud, who returned to Luverne in late March.

"It definitely was a step in the right direction."

As a player with the dream of playing Division 1 college hockey one day, a season like the last one looks good on Smedsrud's resume.

He will continue to pursue his dream by participating in a tryout for the United States Hockey League in Sioux Falls in June, and he plans to attend a few more camps during the summer.

It sounds like Smedsrud would be interested in any offers received as a result of the tryouts. If nothing develops in terms of interest, he wouldn't be opposed to returning to Wilcox and playing one more season with the Hounds in the SJHL.

Considering the tragic

FROM THE SIDELINES

By John Rittenhouse, sports editor

accident that stunned the sports world on April 6, Smedsrud's willingness to return to Wilcox speaks well of his character.

I'm sure most of our readers heard about the semi-bus accident involving the Humboldt Broncos that claimed 15 lives and injured 14 others.

Not only was Humboldt a member of the SJHL, the Broncos compete in the same division (Global Ag Risk Solutions) as the Hounds do.

As a division competitor, the Hounds and Broncos play eight league games against each other during the regular season.

Playing that many games against the same opponent does generate on-ice chatter, leaving Smedsrud a feeling of familiarity with many of the Humboldt players.

Complicating the situation for Smedsrud is the fact that one of the Humboldt players seriously injured during the accident was a former Notre Dame Hound who was traded to the Broncos prior to the 2017-18 season.

"I do have one buddy on the Humboldt team," Smedsrud said, who was clearly uncomfortable talking about the accident.

"He was our assistant captain during my first season (in the league). He has some severe injuries, so he'll have a long road of recovery to travel. They were on a bus traveling to a playoff game, and then that happens. It was just another game and we all travel to them by bus. I don't have words for what I'm feeling right now. It just makes me sick to my stomach."

It's easy to understand the sorrow Smedsrud is experiencing, but I'm glad he's handling it without losing focus on the future.

Sometimes there are obstacles to overcome when one is pursuing a dream, and I give Chaz credit for not giving up on his after that horrific accident.

Dragons test track skills for first time

By John Rittenhouse

The Adrian track teams received their first meet exposure in 2018 at the Cardinal Relays in Luverne Thursday.

AHS was one of 10 schools participating at the annual meet.

The Dragon boys scored 32 points to place eighth in a 10-team field led by Worthington, which claimed the team title with 158 points.

The AHS girls scored 27 points to finish ninth out of nine teams.

Luverne won the girls' team championship with 174 points.

Scot Edwards turned in the top effort for the Dragon boys by placing second in the shot put with a toss of 40-2.

Christian Weidert placed third in the long jump with a distance of 18-8 1/2.

Moriah Bullerman turned in a pair of third-place finishes to highlight the meet appearance for the Adrian girls.

Bullerman finished third in the 800- and 1,600-meter runs with respective 2:44.97 and 6:10.8 efforts.

Here is a look at the rest of the point-producing efforts turned in by the Adrian athletes during the Cardinal Relays.

Adrian boys
 Fourth place: 400 relay (Dakota John, Chance Turner, Tahj Schroeder and Brendyn White), 49.6.
 Fifth place: Dakota John, triple jump, 35-10 1/4.
 Sixth place: Edwards, discus, 100-6 1/2; 800 relay (John, Weidert, White and Ryan Wieneke), 1:43.65; 1,600 relay (John, Schroeder, Weidert and Wieneke), 4:02.61.

Adrian girls
 Fourth place: 800 relay (Erika Alvarado, Hannah Henning, Bailey Lonneman and Kendra Frodermann), 2:02.64.
 Fifth place: Sammy Wieneke, discus, 80-0; 400 relay (Alvarado, Henning, Lonneman and Frodermann), 57.8.
 Seventh place: Elizabeth Erwin, triple jump, 28-8.



Adrian's Brendyn White begins his leg of the 800-meter relay after receiving the baton from Christian Weidert during the Cardinal Relays in Luverne Thursday.

Panther boys score 43 points in Luverne

By John Rittenhouse

The Ellsworth boys' track team turned in a sixth-place performance at the Cardinal Relays in Luverne Thursday.

Competing for the first time this spring, the Panthers scored 43 points to finish sixth among 10 teams at the meet.

Worthington claimed the team title with 158 points.

Ellsworth received one second-place effort and four third-place performances during the meet.

Kade Boltjes registered the top effort by finishing second in the long jump with a distance of 20-0 3/4.

Sean Boltjes had a productive day by placing third in the 110- and 300-meter hurdles with respective 16.57 and 44.03 efforts.

Brandon Kramer finished third in the discus with a toss of 111-4 1/2.

Ellsworth also placed third in the 400-meter relay with a time of 49.43.

Noah Kruse formed the team along with Kade, Sean and Cole Boltjes.

Here is a look at the rest of Ellsworth's point-producing efforts during the Cardinal Relays.

Fourth place: Kramer, shot, 38-5.
 Sixth place: K. Boltjes, triple jump, 35-8 1/4.
 Seventh place: Kruse, 400, 57.55.
 Eighth place: S. Boltjes, long jump, 18-0 1/2.



Ellsworth's Sean Boltjes placed third in the 110- and 300-meter hurdles in Luverne Thursday.

Open/continued from page 2B

Gavin Wysong and Tyson Bork formed the winning team.

Here is a look at the rest of H-BC's point-earning performances during the Cardinal Relays.

H-BC girls
 Third place: Abby Knobloch, 300 hurdles, 56.93.
 Fourth place: Rauk, 100, 13.64.
 Fifth place: Rauk, 400, 1:07.33; 3,200 relay (K.Fick, Taylor Durst, Lauren Tatge

and Ana Hagen), 11:29.09.
 Sixth place: Spath, 100, 14.15; S.Fick, 400, 1:08.15; S.Fick, triple jump, 28-9.
 Seventh place: Taylor Durst, 400, 1:08.42.

H-BC boys
 Fourth place: T.Bork, 100, 12.25.
 Fifth place: H.Bork, 100, 12.25; Garrett Raymon, discus, 103-7.
 Sixth place: Wysong, 100, 12.27.
 Seventh place: 800 relay (H.Bork, LaRock, Wysong, T.Bork), 1:44.02.
 Eighth place: George Merson, shot, 37-2 1/2.

YOU'RE INVITED

Please Join Us For
Coffee at the Exchange

9:00 am - 11:00 am Exchange State Bank
 310 Gabrielson Rd • Luverne, MN

**2018 Coffee at the Exchange Schedule: Coffee & goodies served.
 Tuesday, April 24, 2018**

MARK YOUR CALENDAR & BRING YOUR FRIENDS.
 ENJOY REFRESHMENTS & FELLOWSHIP.

Member FDIC
Local. Dependable. Strong

CD SPECIAL

Guaranteed rates of return.

1.65%
APY*

13 MONTHS

\$5,000 MINIMUM

2.05%
APY*

21 MONTHS

\$5,000 MINIMUM

Fixed term.
Fixed rate.
Guaranteed return.

Minnwest is offering great rates and a variety of terms on our Classic CD.

* APY is Annual Percentage Yield. Yield effective as of April 2, 2018 and subject to change. Substantial penalty for early withdrawal. Fees may reduce earnings.

Minnwest Bank

Doers Welcome!

minnwestbank.com

Member FDIC

April
Spring
Sale

50% off frame
with
purchase
of lenses

Sale ends 4/30/18

Offer cannot be combined with insurance.

Find us on:
facebook.

Rock County
EYE CLINIC

507-283-2345
104 N. Freeman Ave.
Luverne, Minnesota
www.rockcountyeyeclinic.com

Rock County Eye Clinic, locally owned, community involved, clearly different.

Star Herald CHURCH

Page 4B April 19, 2018

St. Catherine Catholic Church
203 E. Brown St., Luverne
St. Catherine Ph.: 283-8502; email: stcatherine@iw.net

Luverne Christian Reformed Church
605 N. Estey St., Luverne
Office Ph. 283-8482; Prayer Line Ph. 449-5982
www.luverncrc.com — office@luverncrc.com
Roger Sparks, Pastor
Sunday, April 22: 9:30 a.m. Worship Service. 10:50 a.m. Sunday School and Catechism Classes. 6:30 p.m. Worship service. Monday, April 23: 9 a.m. Perk-up Edgerton. 7 p.m. Friendship. Tuesday April 24: 9:30 a.m. Coffee Break/Story Hour. Wednesday, April 25: 2 p.m. Faith Builders Bible Study. 7 p.m. Youth Group.

First Baptist Church
1033 N. Jackson St., P.O. Box 975, Luverne
Ph. 283-4091; email: fbcluv@iw.net — www.fbcluverne.org
Wait Moser, Pastor

Thursday, April 19: 6 a.m. Men's Bible Study. 7 p.m. Constitution Review Team meeting. 8 p.m. Worship Service on Channel 3. Sunday, April 22: 9:15 a.m. Sunday School. 10:30 a.m. Worship service. 6 p.m. Baked potato bar and FBC Annual Meeting. Monday, April 23: 1:30 p.m. Ladies' Bible Study. 7 p.m. Ladies' Bible Study. Tuesday, April 24: 7 a.m. Men's Bible Study. Wednesday, April 25: 6:30 p.m. Awana Awards Night. Thursday April 26: 6 a.m. Men's Bible Study. 8 p.m. Worship Service on Channel 3.

Grace Lutheran Church
500 N. Kniss Ave., Luverne
Ph. 507-283-4431; www.graceluverne.org — graceluverne@iw.net
Ron Nichols, Pastor; Stephen Hilding, Associate Pastor

Thursday, April 19: 8:30 a.m. MIA. 1:30 p.m. Lydia Circle at Grace. 6:30 p.m. Executive Ministry meeting. Friday, April 20: 6:30 p.m. Worship on Channel 3. Saturday, April 21: 5:30 p.m. Worship. Sunday, April 22: 8:15 a.m. Radio broadcast. 9 a.m. Worship. 10 a.m. Fellowship; Sunday School; Adult Study. Semi-Annual Meeting; Youth Pie/Basket Auction. Monday, April 23: 4:30 p.m. Worship on Channel 3. 5:45 p.m. Echoes of Harmony rehearsal. Tuesday, April 24: 7 a.m. Dorcas Circle at The Bean. 9 a.m. Staff meeting; Grace Notes assembly. 1:30 p.m. Worship at Mary Jane Brown Home. 2:30 p.m. Worship at Poplar Creek. 4 p.m. Worship at Veterans Home. 7 p.m. Mary/Martha Circle. Wednesday, April 25: 7 a.m. Men's Bible Study. 3:15 p.m. Final Faithweavers. 6 p.m. Woven Worship. 7 p.m. Chancel Choir rehearsal. Thursday, April 26: 11 a.m. to 1 p.m. GLCW Salad Luncheon. 2 p.m. Sarah Circle at Camelot. 7 p.m. Priscilla/Elizabeth Circle at Judy Fenske.

Bethany Lutheran Church
720 N. Kniss Ave., Luverne
Ph. 507-283-4571 or 507-449-0291 or 605-215-9834
pastorapalmquist67@yahoo.com
Andrew Palmquist, Pastor

Sunday, April 22: 9 a.m. Sunday School. 9:15 a.m. Bible Class. 10:15 a.m. Worship with Communion. Wednesday, April 25: 3:30 p.m. Catechism Class.

American Reformed Church
304 N. Fairview Dr., Luverne
Ph. 283-8600; email: office@arcluverne.org
Mike Altena, Pastor

Thursday, April 19: 5:30 p.m. Tumbling Tikes. Friday, April 20: 6:30 a.m. Community Men's Bible Study. 4:30 p.m. REFIT Fitness. Saturday, April 21: 9 a.m. Moss/Richters Bridal Shower. Sunday, April 22: 9:30 a.m. Worship Service. 10:50 a.m. Family Education. 7 p.m. Junior RCYF; Senior RCYF. Tuesday, April 24: 10 a.m. Staff Meeting. 6:45 p.m. Bible Study Fellowship. Wednesday, April 25: 4:30 p.m. REFIT Fitness. 5:30 p.m. Midweek Meal. 6:30 p.m. Pioneer Clubs/YEL. 6:45 p.m. Rachel Circle. 7 p.m. Abide Praise Team. Thursday, April 26: 5:30 p.m. Tumbling Tikes.

First Assembly of God Church
1075 110th Ave., 2 miles west of Luverne on County Rd. 4
Sundays: 9 a.m. Sunday School. 10 a.m. Morning Worship. 6:30 p.m. School of the Holy Spirit. Wednesdays: 7 p.m. Kids Connection; Men's Bible Study with Pastor Ken; Women's Bible Study with Pastor Gloria.

United Methodist Church
109 N. Freeman Ave., Luverne
Ph. 283-4529; email: luverneumc@iw.net
Dorie Hall, Pastor

Thursday, April 19: 1-3 p.m. Rock County Food Shelf. 5-6:30 p.m. Rock County Food Shelf. Saturday, April 21: 9 a.m. to noon Cook and Share Recipe Day in UMC kitchen. 8 p.m. AA Meeting. Sunday, April 22: 9:30 a.m. Traditional Service. 10 a.m. Coffee Hour; Adult Sunday School. 11 a.m. Come as You Are Service. 4:30 p.m. Genesis/Revelation Bible Study. 6 p.m. ALIVE Youth Group. Monday, April 23: 8 p.m. AA Meeting. Tuesday, April 24: 9 a.m. Folding team. Wednesday, April 25: 5:30 p.m. Community meal. (Adrian Boy Scouts help.) 6:30 p.m. F.U.E.L. and Confirmation. 8 p.m. AA Meeting. Thursday, April 26: 1-3 p.m. Rock County Food Shelf.

Steen Reformed Church
112 W. Church Ave., Steen
Ph. 855-2336

Jeremy Wiersema, Pastor
Sundays: 9:30 a.m. Worship; service broadcast on KQAD. 10:45 a.m. Sunday School. 6 p.m. Youth Group. Evening worship at 6 p.m. first and third Sundays. Wednesdays: 7 p.m. Midweek.

St. John Lutheran Church
803 N. Cedar St., Luverne
Ph. 283-2316, Dial-A-Devotion Ph. 283-4005
email: stjoh@iw.net — www.stjohnlutheranluverne.org
Gary Klatt, Pastor

Thursday, April 19: 9 a.m. Little Lambs Devotions. 1 p.m. Parkinson's Support Group. Saturday, April 21: 5:30 p.m. Worship with Communion. Sunday, April 22: 9 a.m. Worship with Communion. 10:15 a.m. Christian Education Hour. 4 p.m. Little Lambs Silent Auction; Junior LYF. Wednesday, April 25: 9 a.m. and 1 p.m. Little Lambs Devotions. 9:30 a.m. Bible Study. 6:30 p.m. Youth supper. 7 p.m. final KFC; final High School Bible Study; Senior Choir. 8 p.m. Youth Board meeting. Thursday, April 26: 9 a.m. Little Lambs Devotions. 9:45 a.m. Rock County Ministerial Association at American Reformed Church. 11:30 a.m. DCE devotions at Mary Jane Brown Home.

Living Rock Church
500 E. Main St., Luverne
Ph. 449-0057; www.livingrockswmn.org
Billy Skaggs, Pastor

Sundays: 10:30 a.m. Worship; Kids Rock Children's Ministry. 6 p.m. Youth Ministry. Life groups meet throughout the week.

New Life Celebration Church
110 N. Oakley, Luverne
Ph. 449-6522; email: newlifecel@iw.net

Sundays: 9:30 a.m. Worship at 110 N. Oakley. Every third Thursday: 4:30 p.m. Food give-away at Senior Citizens Center. Bible Study groups meet at various times and days.

Zion Evangelical Lutheran Church
305 E. 2nd St., P.O. Box 36, Hardwick
Ph. 669-2855; email: www.zionlutheranhardwick.com

Thursday, April 19: 3:30 p.m. Worship on Channel 3. Friday, April 20: 3:30 p.m. Worship service on Channel 3. Sunday, April 22: 9 a.m. Sunday School and Adult Bible Study. 10 a.m. Mentor Program. 10:30 a.m. Worship Service. Monday, April 23: 1 p.m. Quilting and Haiti Projects workday. Tuesday, April 24: 7 p.m. Women's Bible Study at church. Wednesday, April 25: May Newsletter deadline. Thursday, April 26: 3:30 p.m. Worship on Channel 3.

Ben Clare United Methodist Church
2672 Ben Clare Ave., Valley Springs, S.D.
igtwb@WOW.net
Bill Bates, Pastor

Sundays: 9 a.m. Worship; 10 a.m. Fellowship; 10:30 a.m. Sunday School for all ages.

First Lutheran Church
300 Maple St., Valley Springs, S.D.
Ph. (605) 757-6662

Sunday, April 22: 9:30 a.m. Sunday School. 10:30 a.m. Worship Service. Wednesday, April 25: 7 p.m. Confirmation.

Palisade Lutheran Church
211 121st St., Garretson, S.D.
Ph. (507) 597-6257 — firstpalisade@alliancecom.net
Intern Pastor Laura Phillips

Sunday, April 22: 9 a.m. Worship service. 10 a.m. Sunday School. Wednesday, April 25: 7 p.m. Confirmation at First Lutheran. Thursday, April 26: 1:30 p.m. WELCA regular meeting.

First Presbyterian Church
201 S. 3rd St., P.O. Box 73, Beaver Creek
Ph. 507-935-5025
Email: lori.firstpres@gmail.com

Sundays: 9:30 a.m. Morning Worship. 10:30 a.m. Sunday School.

Magnolia United Methodist Church
501 E. Luverne St., Magnolia
Church Ph. 507-483-2492; cell 227-7821; email: adrmagumc@gmail.com
www.facebook.com/adrianmagnoliaumc
Kristi Franken, Pastor

Sundays: 9 a.m. Magnolia Worship Service. Wednesdays: 6:30 p.m. Confirmation.

Bethlehem Lutheran Church
Pastor Maggie Berndt-Dreyer
112 N. Main St., Hills
Ph. 962-3270
e-mail: bethlehmluth@alliancecom.net

Sunday, April 22: 9 a.m. Worship at Tuff Chapel. 9:30 a.m. Sunday School. 10:30 a.m. Communion at Bethlehem. 7 p.m. Grades 6-8 Youth Night. Tuesday, April 24: 2:30 p.m. Bible Study at Tuff. 3:15 p.m. Bible Study at the Village. Wednesday, April 25: 9 a.m. Quilting. 6:30-8 p.m. Confirmation and Mentors.

Hills United Reformed Church
410 S. Central Ave., Hills
Office Ph. 962-3254
hillsurc@alliancecom.net
Alan Camarigg, Pastor

Sundays: 9:30 a.m. and 6 p.m. Worship Services.

Resurrection proves you are forgiven

Where is the evidence? We are fortunate to live in a country where one must be proven guilty. The presumption of innocence is central to our legal system. The lawyers involved in a court case present evidence to support their claims of guilt or innocence for the accused. A baseless claim will be met with the question, "Where is the evidence?"

All truth claims should be proven valid by supporting evidence. Christianity is held to the same standard. What are some of the truth claims of Christianity?

The first is that everyone is sinful. The evidence for this is overwhelming. Just think. Have you ever told a lie? Have you ever taken something that didn't belong to you? Have you ever had sexual desires for someone who is not your spouse? Have you ever hated someone? The evidence proves that you and I are sinful.

The Bible claims that God sent His Son, Jesus the Christ, to live a perfect life, to suffer and die innocently, and to rise triumphant from the grave so that the sins of all people are forgiven. It says, "He was delivered over to death for our offenses, and raised to life for our justification (forgiveness)." (Romans 4:25) The resurrection is the crux of the matter. If Jesus rose from the grave, then everything else claimed holds true.

What evidence is there for the resurrection of Jesus? Here are some things to consider.

- The disciples never changed their story. There are no inconsistencies in the different accounts of the resurrection.
- The disciples were willing to die for their faith

BUILT ON A ROCK

By Rev. Andrew Palmquist, Bethany Lutheran Church, Luverne

in the resurrected Jesus. All of the Apostles but John were martyred – killed for their faith. Why would they die for a lie?

•Over 500 men saw the resurrected Jesus at the same time. Jesus appeared to people for 40 days after He was raised to give many convincing proofs that He was alive.

•Where is the body? No event has had such a great impact on the world. To prove Christianity a hoax, all one must do is produce the body of Jesus. His enemies certainly would have if it was possible. But they haven't because Christ is risen. He is risen indeed!

The resurrection of Jesus is a valid event in human history. It really happened. Therefore, everything that the Bible claims about Jesus is true. He did live a perfect life. He did die an innocent death for the sins of all people. He rose from the grave to prove that God has accepted Jesus' sacrifice on our behalf. Here is the greatest claim: Your sins are forgiven. Jesus' resurrection proves that it is true!

Come to God's House on Sunday and celebrate the risen and living Savior. Celebrate the resurrection because it proves that Jesus kept His word, He really loves you, and you and I are truly forgiven!

First Presbyterian Church
302 Central Lane, Luverne
Ph. 283-4787; email: Firstpc@iw.net — www.fpcuverne.com
Jason Cunningham, Pastor

Thursday, April 19: 10 a.m. Worship on Channel 3. Sunday, April 22: 9 a.m. Sunday School. 10:15 a.m. Worship service. 11:15 a.m. Fellowship. Monday, April 23: 9 a.m. Quilting Group. Tuesday, April 24: 10 a.m. and 6 p.m. Worship on cable access channels. Wednesday, April 25: 6 p.m. Bells. 6:30 p.m. HS Fellowship. 7 p.m. Choir practice. 8 p.m. Deacons. Thursday, April 26: 10 a.m. Worship on cable access channels.

These Weekly Church Page Messages are contributed to God's Work through the Church and by these concerned and responsible citizens & businesses:

Call Rick or Chantel to place your ad!

283-2333

Tuff Memorial Home, Retirement Apartments & Tuff Village
"A Home Where Residents SMILE"
Hills, Minnesota
Phone 507-962-3275

Papik Motors
LUVERNE, MINN.
I-90 in Luverne, MN
507-283-9171 • 1-800-634-7701

Read us online!

Rock County
STAR HERALD
www.Star-Herald.com

Trust In Him



Pizza Ranch
110 E. Main, Luverne, MN
Phone 507-283-2379

MANLEY
TIRE & OIL SERVICE
Manley Minnesota
1-800-615-3704
Open six days a week - Closed on Sundays
To God be the Glory.

CWG
Business Insurance.
Tri-State Region *Period!*

Rock County
STAR HERALD
Luverne, MN • 507-283-2333

Advertise Here

Luverne ANNOUNCER

To Advertise Call 283-2333

Buffalo Ridge INSURANCE
507-283-2381 www.buffaloridgeins.com E-mail:info@buffaloridgeins.com

McClure Electric
Alan M. Aanenson, owner
Farm, Home & Commercial Wiring
Luverne, MN Phone 507-283-4716

First Farmers & Merchants
303 E. Main, Luverne, MN
507-283-4463
www.ftmbank.com
We believe in you.
Member FDIC. And the community.

HILLS STAINLESS STEEL & EQUIPMENT CO., INC.
506 W. Koehn, P.O. Box 987, Luverne, MN
PHONE 507-283-4405
Church is Important - Please Attend!

MINNWEST BANK
• 116 E. Main St., Luverne 507-283-2366
• S. Hwy. 75, Luverne 507-283-9131
• Main St., Beaver Creek 507-473-2333
Member FDIC www.minnwestbank.com

HARTQUIST
Funeral and Christian Services
- ENGBRETSON CHAPEL -
507-283-2777
www.HartquistFuneral.com
"Let our family help your family"
Serving the Luverne and Surrounding Communities

Tollefson Publishing
117 W. Main
Luverne, MN 56156
507-283-2333

Star Herald PUBLIC NOTICES

Bridge replacement bids due May 14

NOTICE TO CONTRACTORS
BRIDGE REPLACEMENT & APPROACH GRADING / S.A.P. 067 - 599 - 178
BIDS CLOSE @ 11:00 A.M. MAY 14, 2018
LIVERNE, MINNESOTA

Sealed ***Bid Packets*** will be received by the Rock County Highway Department at Luverne, Minnesota until **11:00 A.M. on Monday, May 14, 2018.**

READ CAREFULLY THE PROVISIONS FOR THE WAGE RATES AS CONTAINED IN THE PROVISIONS, AS THEY WILL AFFECT THIS PROJECT.

Attention is called to the fact that the contractor must comply with the **Special Equal Employment Opportunity Provisions & Wage Rates** as contained in this Proposal.

Proposals will be opened and read publicly in the presence of the Rock County Highway Engineer at the Rock County Highway Building located at 1120 North Blue Mound Avenue in Luverne, MN immediately following the hour set for receiving bids for the following Rock County Highway work. Bids will be awarded on Tuesday, May 22, 2018 at the regular Board of Commissioners Meeting.

Construction of Bridge 67573, a 107' Concrete Slab Span. The project is located in Luverne Township, 1 Mile North of C.S.A.H. 15 on 144TH Avenue, over Elk Creek.

The major items of work are: 75 Cu. Yd. Structural Concrete; 3,317 Sq. Ft. of Bridge Slab Concrete; 214 Lin. Ft. of Type S (TL-4) Railing Concrete; 54,970 Pounds of Reinforcement Bars (Epoxy Coated); 670 Cu. Yds. Random Riprap (Class III); 360 Lin. Ft. 12" - C-I-P Piling; 2 - 12" C-I-P Test Piles 70 Ft. Long; 600 Lin. Ft. 16" - C-I-P Piling; 2 - 16" C-I-P Test Piles 85 Ft. Long; & Approach Work.

Plans, specifications, and proposals may be viewed, and downloaded at www.questcdn.com and at the Rock County Highway Department website, www.co.rock.mn.us/highway. Questions may be directed to the office of the Rock County Highway Engineer, 1120 North Blue Mound Avenue, P.O. Box 808, Luverne, Minnesota 56156-0808 / (507) 283 - 5010.

The **non-refundable cost for plans and one proposal will be \$30.00.**

Bids must be accompanied by a certified check or corporate surety bond drawn in favor of the Rock County Treasurer in the amount of at least five percent (5%) of the proposal.

Sealed bids shall be clearly marked **"PROJECT NO. S.A.P. 067-599-178"**

The Board of Rock County Commissioners reserves the right to reject any or all bids and to waive any defects therein.

Rock County is an Equal Opportunity/Affirmative Action Employer.
 Mark R. Sehr, P.E.
 Rock County Highway Engineer
 (4-19, 4-26, 5-3)

City of Luverne adopts Ordinance No. 364

ORDINANCE NO. 364, THIRD SERIES

AN ORDINANCE AUTHORIZING CONVEYANCE OF REAL ESTATE (ROUNDWIND ADDITION, CITY OF LUVERNE, ROCK COUNTY, MN)

THE CITY OF LUVERNE DOES HEREBY ORDAIN:

SECTION 1. Pursuant to City Charter, Section 12.05, the City Council is authorized to sell or convey the following described real estate located in the City of Luverne, County of Rock, State of Minnesota, described as follows, to-wit:

That part of Lot 1, Block 1, Tri-State Addition to the City of Luverne, Minnesota described as follows:

Commencing at the Southeast Corner of said Lot 1; thence Northeasterly on the perimeter of said Lot 1 and on the arc of a curve to the left, concave Northwest having a radius of 405.00 feet for an arc distance of 170.13 feet (said curve subtended by a chord which bears North 37°07'24" East with a chord distance of 168.89 feet) to the Point of Beginning; thence continuing on said perimeter and on said curve for an arc distance of 522.02 feet (said curve subtended by a chord which bears North 11°50'11" West with a chord distance of 486.63 feet); thence Westerly on a compound curve to the left having a radius of 245.00 feet for an arc distance of 304.87 feet (said curve subtended by a chord which bears North 84°24'37" West with a chord distance of 285.58 feet); thence South 33°48'51" East for a distance of 349.05 feet; thence South 56°14'14" West for a distance of 151.00 feet; thence South 67°34'04" East for a distance of 341.13 feet to the Point of Beginning.

The above description contains 2.99 acres.
 To Cleveringa Construction, Inc.

SEC. 2. The Mayor and City Administrator are hereby authorized and directed to execute such legal documents as are necessary, including but not limited to a development agreement, to accomplish this sale and are further authorized to execute and deliver a warranty deed upon complete fulfillment of all terms and conditions.

SEC. 3. This ordinance takes full force and effect seven (7) days after its publication.

/s/ Patrick T. Baustian, Mayor
 /s/ John M. Call, City Administrator
 (4-19)

MISCELLANEOUS

HAVE A UNIQUE SERVICE OR BUSINESS? Get the word out to over 1.4 million households. Call WIDE AREA CLASSIFIEDS today, 507-359-7326. (tc)

SERVICES

Handy Man: if you are looking for someone to do those extra things that don't get done or repaired, odd jobs, small jobs, I also do some landscaping. Call Darwin Brands at 507-290-0174. (4.19-5.27)

FOR SALE

Spruce trees for sale by Pipestone County Pheasants Forever. Four year old trees, 18 inches tall. \$2.50 each (sold in lots of 50) Call 507-825-3914. (4.15-4.19)

GARAGE SALES

Huge Five-Family Rummage Sale. April 20-21 at 403 and 405 Tennessee Ave Adrian. Friday 8 a.m. to 6 p.m. Saturday 1 a.m. to 1 p.m. Women's and men's jeans, teen blouses large through 5X, kitchen stuff, lots of shoes and purses, hutch, table and chairs and misc. Cash Only. (4.15-4.19)

Garretson, SD Annual Early Bird City Wide Rummages. Thursday, April 19 - Saturday, April 21. Various hours. Listings available to GFC, Jesse James, Treasure Chest. Great Bargains. Snow, rain or shine! (4.15-4.19)

RENTALS

For Rent: one-bedroom apartment near downtown Luverne. \$290 per month. No Pets. Call 605-201-6427. (tc)

FOR LEASE

3 Bedroom at Rock Creek Townhomes
 \$630/mo Includes water, sewer, trash, W/D hook-ups, garage
 Section 8 Welcome -
 Income Restrictions Apply
 (507) 220-0757
 LloydManagementInc.com
 Equal Housing Opportunity

Oakwood Apartments

401 Oak St., Ellsworth

• **1 Bedroom Unit Available**
 Unit Available
 Water, Sewer &
 Garbage Included.
 Rent Based on Income
AVAILABLE IMMEDIATELY
 Van Binsbergen
 & Associates, Inc.
 320-269-6640 ext. 22
 Equal Housing Opportunity
www.vanblc.com

GARAGE SALES

40th Annual Kingswood Rummages in Sioux Falls

Wednesday, April 25 - Friday, April 27
 8 a.m. - 9 p.m.
Saturday, April 28
 8 a.m. - 5 p.m.
Individual sale dates and times will vary.
Primary Kingswood Area
 I-29 on the East, Sertoma Avenue on the West, 41st Street on the South and Coughran Court on the North.
 For a listing of rummages go to
www.kingswoodrummage.com
 on Friday, April 20.
OVER 300 RUMMAGES!

CARDS OF THANKS

Thank you to the volunteers who made the American Red Cross drive great. The blood donors, the kitchen help, the greeters, Grace Lutheran Church for the use of the facilities and to the American Legion Auxiliary 123 for paying for the sandwiches, chips and milk. (4.19-4.22)

The family of Lois Kindt would like to convey our gratitude for the expressions of sympathy, cards, food, flowers, and memorials during our recent loss. Thank you to Pastor Klatt, Zion Lutheran Church members -especially those who assisted with the funeral and meal, Luverne Hospice, Jeff Hartquist and his Staff. A special thanks to all the Staff at the MN Veterans Home who gave Lois such excellent care. Your kindness will be forever in our hearts.

**Harold Kindt
 Dawn, Dan and Joan,
 Dave and Christie,
 Darin and Diane
 and Families**
 (4.19-4.22)

EMPLOYMENT

PCA /CNA needed for in home care of a middle aged woman in the Lismore area. 25 hours a week guaranteed, Monday through Friday in the mornings. Duties will include helping with personal care and additional activities as needed. This is an excellent long-term position in a comfortable smoke free/pet free setting. For more information, or to submit a resume, please send email to bsl_1960@gmail.com 4.19-5.6)

Oasis Care Home is now hiring various weekend shifts and for full-time Monday through Friday 2:30 - 10 p.m. for a CNA. \$13.50 per hour. Call Mandy at Oasis Care Home for more information at 507-449-6156. (4.15-5.3)

Help Wanted: Age 55+ workers needed for part-time custodial work at Adrian and Beaver Creek Rest areas. Contact Green View at 651-639-1913. (4.15-5.3)

EMPLOYMENT

New Prairie Insulation of Beaver Creek has a full-time Insulation Installer position available. Monday through Friday, health insurance, vacation, holiday, retirement plan, bonus opportunities. Will train. Call Dean at 605-376-3006 or 507-673-2548. (tc)

Help wanted: Someone for general housework and personal care 1 day every 2 weeks for 5 hours a week total. Also for yardman to work 4 hours once a week every week. Call 507-669-2585 (4.8-4.26)

EMPLOYMENT

NEED EXTRA CASH?

Luverne Announcer Carriers needed for **LUVERNE**

Call **283-2333** or stop in at the Announcer office (ask for Jenn)

Sanford Luverne Medical Center is currently accepting applications for FT (Full-Time), PT (Part-Time) and PRN (Part-Time as Needed) positions:

CERTIFIED MEDICATION ASSISTANT - FT, PRN

HOME HEALTH AIDE - PRN

LPN, HOSPICE - FT, PRN

To apply, visit sanfordhealth.jobs search "Luverne" in the location search bar.

SANFORD HEALTH

"Your Calling, Your Place."

Sanford Luverne Medical Center | 877-673-0854

EEO/AA

Seasonal public works worker

The City of Luverne is seeking applicants for the 2018 summer season in the Public Works Department. Job duties include various types of manual labor and operation of light equipment in the maintenance of City streets, parks, and landscaping. These are seasonal positions and not intended to last beyond late summer or early fall. Desirable qualifications: Valid Class D driver's license, building or grounds maintenance experience and good driving record. Pay will be based on experience and qualifications; min. \$11.11/hr. Applications will be accepted until positions are filled, first review date April 27, 2018. Application packets are available online at www.cityofluverne.org or from City Clerk Jessica Mead at City Offices, 305 E. Luverne Street, PO Box 659, Luverne, MN 56156 (507) 449-9898. EOE.

Luverne
Love the life!

Smithfield Sioux Falls Join our Team and Meat Your Future

Production Team Members
 • \$14.35—\$18.60 per hour

Plant Maintenance, Electrical/Electronic & Refrigeration/Boiler Technicians

• \$17.55—\$26.53 per hour
 • Excellent Training Program



See all our sizzling hot careers at:

www.smithfieldfoods.com/career

or Call 605-330-3354

Smithfield

Good food. Responsibly.®

Smithfield is an EEO/AA Employer

CITY OF LUVERNE *Love the life!*

PUBLIC WORKS WORKER

The City of Luverne is accepting applications for a full-time Public Works Worker Position. Duties include routine to semi-skilled manual and maintenance work with city parks, grounds and buildings. Full-time, union position, starting salary range of \$11.11-\$19.06/hour (DOQ) and excellent benefits package.

Minimum requirements include: High School Diploma or equiv., one year of experience in equipment operation and maintenance, valid Minnesota Class B driver's license, 10-mile response area requirement must be met within 6 months of hire, satisfactory driving record, and must meet Federal DOT regulations.

See job description for qualifications & further details.
 Applications available at: City Offices, 305 E. Luverne St., Luverne, MN 56156; (507) 449-9898; or at www.cityofluverne.org

Applications must be received by 4:00 p.m. on Friday, May 4, 2018
 The City of Luverne is an Affirmative Action/Equal Employment Opportunity Employer.

Your Access To Local News Just Got More Expensive.

The U.S. government just imposed a new tax on newsprint, increasing the cost of the paper you are holding. These tariffs hurt newspapers, readers, workers and local communities.



PROTECT YOUR RIGHT TO READ.
 TELL YOUR REPRESENTATIVES IN CONGRESS TO STOP THE TARIFFS ON NEWSPRINT.
202.225.3121
stopnewsprinttariffs.org



Star Herald CLASSIFIEDS

EMPLOYMENT

Looking for a NEW CAREER?



RN / LPN - \$25.50
Night Shift, MN Nursing License Required
Benefits: Excellent PERA, PTO and holiday pay.
Wages based on experience.

CNA - \$13.00
\$2,000 scholarship for students
Benefits: Health insurance, PERA retirement plan and holiday pay.

Dietary Assistant / Cook
Call for details

Maintenance Director
Call for details

Contact Darnell Krull - RN
507-967-2388 or dkparkviewmanor@frontiernet.net

EMPLOYMENT

EMPLOYMENT

EMPLOYMENT

CHS Truck Drivers - Seasonal

Wanted- **CHS needs seasonal truck drivers** in the towns listed below. For seasonal truck drivers a CDL and clean driving record are preferred. Also looking for Drivers for evening and weekend shifts. Hazmat and Tanker preferred but not required.

Drivers are needed at the following locations: Colton SD, Garretson SD, Worthing SD, Elkton SD, Magnolia MN, Ruthton MN, Tracy MN, and Marshall MN.

If you are interested in applying, please email your contact info and qualifications to kyle.heronimus@chsinc.com or call 605-582-2415 and ask for Kyle.

To see complete job posting and apply online, visit www.chsinc.com/careers. Click on: Careers / under CHS Opportunities find "CHS career search here" then click Search Openings and enter ID# 11078.

CHS Inc. is an EEO employer.



POSITION AVAILABLE

Rock and Pipestone County Farm Service Agency (FSA) have an immediate opening for a temporary, part-time Field Assistant. The incumbent is responsible for all compliance field work for the Rock and Pipestone County FSA Offices and performs a broad range of field compliance activities related to price support, commodity production and conservation. Starting pay is \$14.30 or \$16.00 per hour, depending upon experience. Position is located at the Rock County FSA Office, 500 W Gabrielson Road, Luverne, MN 56156, tel. 507-283-2369, or the Pipestone County FSA Office 119 2nd Avenue SW, Suite 7, Pipestone, MN 56164, tel. 507-825-5478. Applications must be filed on Form FSA-675 and may be obtained from either County FSA Office, or online. Applications will be accepted at the Rock and Pipestone County FSA Offices through close of business April 30, 2018. For questions, please contact either County Office. FSA is an Equal Employment Opportunity Employer.

ROCK COUNTY SUMMER EMPLOYMENT

Rock County is accepting applications for summer help positions at the Highway Department until May 2, 2018. The positions are full-time temporary/seasonal and will work with a variety of projects in providing assistance with the following activities: general maintenance duties at the Highway Department and Transfer Station; may also provide assistance with the engineering department of the Highway Department. Applicants must be 18 years of age, possess a valid driver's license and have the ability to stand for long periods of time, along with bending, stooping and the operation light equipment; minimum pay is \$11.50 per hour.

Job applications are available at www.co.rock.mn.us/employment or by contacting the Rock County Administrator's office at the Rock County Courthouse in Luverne, Minnesota at 507-283-5065 or by email to susan.skattum@co.rock.mn.us. Office hours are from 8:00 a.m. to 5:00 p.m., Monday through Friday. Applications will be accepted until all positions are filled.

An Equal Opportunity Employer

EMPLOYMENT NOTICE FOR ROCK/NOBLES COMMUNITY ASSISTANT CORRECTIONS AGENT

The Rock County Administrator's Office is currently accepting applications for an Assistant Corrections Agent for the Rock/Nobles Community Corrections organization until **May 11, 2018**. This position will provide assistance to agents by conducting pre and post dispositional activities along with miscellaneous administrative work; duties include but are not limited to: conducting initial interviews and investigation of clients, makes recommendations to supervising officer/agent, completes necessary reports and legal correspondence, and enters case documentation into appropriate electronic databases. This is a full time and benefit eligible position with an hourly range of \$20.71 minimum and maximum of \$29.48.

Applicants must possess one of the following: a Bachelor's degree in Criminal Justice, Sociology, Psychology, Social Work, or related field required, with a minimum of one year experience as an adult and/or juvenile agent OR an Associate's degree in Criminal Justice, Sociology, Psychology, Social Work or related field with three (3) years of full time, paid experience working for a correction/social services agency. Must also possess a valid driver's license.

A full job description, application or general questions for this position can be obtained at <http://www.co.rock.mn.us/employment.html>; or by email: susan.skattum@co.rock.mn.us or contact the Rock County Administrator's office at 507-283-5065. Office hours are from 8:00 a.m. to 5:00 p.m., Monday through Friday

An Equal Opportunity Employer

Southwestern Mental Health Intake Specialist

Southwestern Mental Health Center is currently seeking applications for a Full-Time Intake Specialist position at our Luverne, MN office. Hours are Monday – Friday, 8 AM to 5 PM, with extended hours on Monday from 8:00 AM to 7:00 PM.

The Intake Specialist is responsible for the general functioning of the Front Office duties. Provide face-to-face and phone reception services to all clients, families, vendors, agencies, and co-workers. Enters new client data into Information System, completes clinical transactions in system. Assist Lead Intake Specialist with completing Initial Intake packets, Face-to-Face Intake packets, consent to treatment agreement, fee agreements and release of information & annual updates.

Knowledge of Microsoft Office Suite. Must be able to perform basis operations on a computer within the Windows operating system.

Apply online at Southwestern Mental Health
Please apply at: <http://www.swmhc.org>

1. Click on the Careers tab toward the top of the web page.
2. Click on Search for Jobs.
3. In the Quick Search, click on Positions by Locations.
4. Click on Luverne, MN and search for this position to apply.

If you need further assistance,
Email: david.vinzant@swmhc.org
Phone: 507-283-9511

EEO/AA



Join us for our **SALAD LUNCHEON** EVERYONE WELCOME!

Grace Lutheran Church, Luverne
Thursday, April 26 • 11 a.m. - 1 p.m. • Adults \$6
Sponsored by the GLC Women

BUY THREE BOTTLES OF BACK WALL WINE AND GET ONE BOTTLE OF HAWK CREST FREE!

Luverne Blue Mound Liquor
\$19 W Main St., Luverne 507-449-5052
Follow us on Twitter @bluemoundliquor & Instagram luvernebluemoundliquor



Sunday Brunch
Every Sunday
10 a.m. - 2 p.m.

- ROAST BEEF • HAM
- BACON • SAUSAGE
- EGGS • FRENCH TOAST
- AND LOTS MORE!

Adults \$10.95
Kids under 13 \$7.95

GREEN LANTERN CAFE & BAR
HARDWICK, MN
507-669-2246

You are invited to discover the world with **TRAFALGAR** at All About Travel, Inc.!

Please join us for a fun-filled evening as we learn about all that Trafalgar guided tour has to offer! Trafalgar has been creating exceptional guided vacations for almost 70 years. With more than 230 trips to worldwide destinations, including Europe, North & Central and South America, and New Zealand.

April 24 • 6 P.M.
All About Travel
3801 S. Western Ave
Suite 103
Sioux Falls, SD 57105

Please RSVP to hold your spot!
Call us at - 605-339-8911
Email us at - aat@allabouttravel.org
Sign up on our website: www.allabouttravel.org

ALL ABOUT TRAVEL INC. PERSONAL BEST!
10-Year Winner! Layaway & Gift Certificates Available!
605-339-8911 • 1-800-390-6610
3801 S. Western Ave., Suite 103, Sioux Falls, SD
Open: Mon.-Fri. 8 a.m. - 7 p.m. • Saturday 9 a.m.-1 p.m.
www.AllAboutTravel.org www.facebook.com/AllAboutTravelInc
Helping You Find Your Personal Paradise!

PALACE THEATRE UPCOMING EVENTS

April 20 - 22 • 7 p.m. on Fri. & Sat., 2 p.m. on Sun.
Movie - "I Can Only Imagine"

April 26 (Thursday) • 2 p.m.
Afternoon Escape Movie - "Only the Brave"

April 29 (Sunday) • 2 p.m. (Rescheduled)
Silent Movie - "The Freshman"
Featuring organist, Leona Hoek

Find us on Facebook
Palace Theatre Luverne

PALACE THEATRE

104 E. MAIN ST. • PO BOX 541 • LUVERNE, MN 56156
507.283.4339 • WWW.PALACETHEATRE.US

ONLINE TICKETING
Online ticketing is now available!
This will be for live events (not movies).
Log on to www.palacetheatre.us to order!

Box office is open
Monday - Friday 12 p.m. - 5 p.m.
507-283-4339



Minnesota Classified Advertising Network



AUCTIONS

SATURDAY, APRIL 28TH 10:00 A.M.
190 Expo Center, 1010 70th Ave., Sherburn MN, 56171. Thousands of 30's-70's Ford parts, neon signs. Model A pickup. '58 Cadillac barn find, Six other Cadillacs, 4 Lincolns. MN # 22-75
www.hallbergauktion.com 800/373-2255

SEED/FEED/GRAINS

LOSING SOYBEAN YIELD
to white mold? New EPA registered seed treatment - Heads Up Plant Protectant, now available. Ask your seed dealer. Call 866/368-9306 or www.headsupST.com

EMPLOYMENT

ADVERTISING SALES MANAGER
needed for family-owned weekly newspaper company in lakes area of West Central Minnesota. Organized? Energetic? Creative? Interested? Contact Ted at kbanner@tds.net

ADVERTISE HERE STATEWIDE IN 260+ NEWSPAPERS FOR ONLY \$279 PER WEEK! CALL 800-279-2979

WANTED TO BUY

MOTORCYCLES WANTED
Cash paid for old motorcycles sitting in the barn or shed. Non-running, no titles OK! Local buyer always paying more! 320/420-7675

WANTED: MOTORCYCLES
1970's & 1960's Era: 2-stroke & 4-stroke. Easy CASH to you! Call: 612/655-3320

WANTED TO BUY OR TRADE

WANTED DEAD OR ALIVE
1900-1979 Vintage motorcycles. Top cash paid. Call 920/371-0494

CLASS ACTION LAWSUIT

WERE YOU AN INDUSTRIAL OR CONSTRUCTION TRADESMAN
and recently diagnosed with lung cancer? You and your family may be entitled to a significant cash award. Call 855/782-2405 for your risk-free consultation.

HEALTH

SAVE ON MEDICARE SUPPLEMENT INSURANCE
Get a fast and free rate quote from Medicare.com. No cost! No obligation! Compare quotes from major insurance cos. Operators standing by. Call 844/504-0156

MISCELLANEOUS

DONATE YOUR CAR
truck or boat to Heritage For The Blind. Free 3-day vacation, tax deductible, free towing, all paperwork taken care of 800/439-1735

DISH NETWORK
190+ channels. Free install. Free hopper HD-DVR. \$49.99/month (24 mos.) Add high speed internet - \$14.95 (where avail.) Call today & save 25%! 855/562-4309

STOP OVERPAYING FOR YOUR PRESCRIPTIONS!
Save! Call our licensed Canadian & International pharmacy, compare prices & get \$25.00 OFF your first prescription! Call 877/210-2257 Promo Code: CDC201725

SPECTRUM TRIPLE PLAY
TV, Internet & Voice for \$29.99 ea. 60 MB per second speed. No contract or commitment. More Channels. Faster Internet. Unlimited Voice. Call 844/290-5838

A PLACE FOR MOM
The nation's largest senior living referral service. Contact our trusted, local experts today! Our service is free/no obligation. Call 844/347-2104

**THINK YOUR FIRE IS OUT?
CHECK AGAIN!**

Embers from debris piles can remain hot for days, even weeks.



m DEPARTMENT OF NATURAL RESOURCES
GREAT LAKES FOREST FIRE CONTACT



Earth Day

helps remind us that we need to stay in a green state of mind all year long!

Celebrate Earth Day locally!

- ⇒ Ride your bike
- ⇒ Make a recycling plan
- ⇒ Fix leaky faucets
- ⇒ Plant a tree
- ⇒ Give up bottled water
- ⇒ Buy local
- ⇒ Plant a garden
- ⇒ Help clean up your community



Remember to Reduce - Reuse - Recycle!



- ⇒ Recycling, reuse and remanufacturing account for 3.1 million jobs in the U.S.
- ⇒ Recycling saves 3 to 5 times the energy that waste incinerator power plants generate.
- ⇒ By reducing our waste 1% per year and recycling and composting 90% of our discards by 2030, we could save 406 megatons of carbon dioxide equivalent every year. This is the equivalent to shutting down 21% of our nation's coal-fired power plants.
- ⇒ More than 76% of cardboard boxes and 72% of newspaper were recycled in 2006 but less than 50% of printing and writing paper was recycled.

Thanks to these businesses for taking pride in their community and sponsoring this promotional page!

Agri-Energy, LLC/Gevo
 Blue Mound Area Theatre
 Cattnach Insurance
 CHS Farmer-Owned with Global Connections
 Connell Car Care
 Continental Western Group
 Cragoe Realty
 Eisma & Eisma
 Estenson Company, Inc.
 Exchange Bank-Luverne Member FDIC
 First Farmers & Merchants Member FDIC
 Hartquist Funeral Home Luverne Chapel
 Heidebrink & Associates
 Jensen Management Services, Inc.

Ketterling Services, Inc.
 Klosterbuer & Haubrich
 Kozlowski Insurance Agency
 Lewis Family Drug
 Luverne Country Club
 Luverne Lanes
 Luverne Schools
 Mark's Plumbing, Heating and AC/LLC.
 McClure Electric
 Meulebroeck & Taubert Co.
 Minnwest Bank Member FDIC
 Papik Motors
 Real Estate Retrievers
 Rock County

Community Transit Serving Rock County
 Rock County Chiropractic
 Rock County Opportunities, Inc.
 Rock County Star Herald
 Rock Veterinary Clinic
 S&S Carwash
 Skattum's Confinement/Superior Buildings
 St. Catherine Church
 St. John/Little Lambs
 Stroeh's Auto Center
 Sudenga Communications
 SW Mental Health
 Teals Market
 Vander Kooi Law Office